

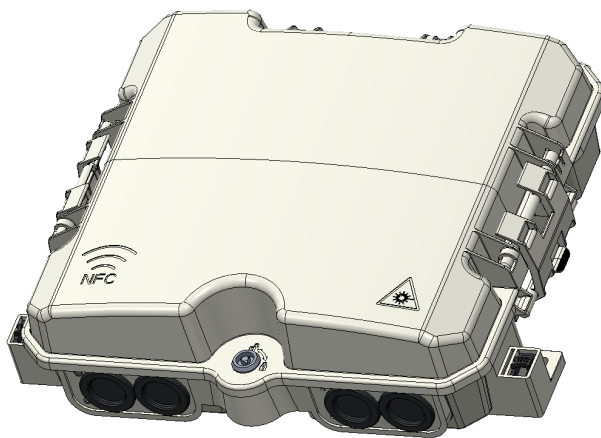

#smartconnection

INSTRUCTIONS / NOTICE



@XS-BOX L

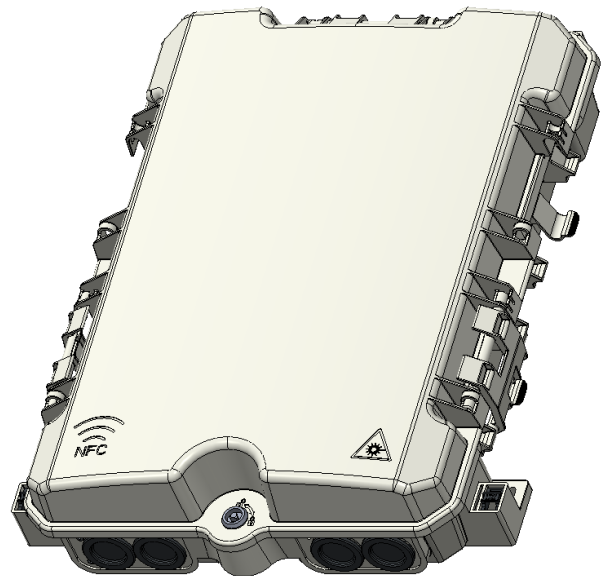

@XS-BOX XL

## @XS-BOX L/XL Patching

# Table of contents

## Table des matières

<b>1. OVERVIEW</b>	
<b>DESCRIPTION</b> .....	<b>3</b>
1.1. PRODUCT PRESENTATION <i>PRÉSENTATION DU PRODUIT</i> .....	3
1.2. DIMENSIONAL CHARACTERISTICS <i>CARACTÉRISTIQUES DIMENSIONNELLES</i> .....	4
<b>2. BOX INSTALLATION</b>	
<b>INSTALLATION DU BOÎTIER</b> .....	<b>5</b>
2.1. FIXATION MURALE <i>WALL MOUNTING</i> .....	5
2.2. OPENING <i>OUVERTURE</i> .....	6
2.3. CONFIGURATIONS <i>CONFIGURATIONS</i> .....	8
<b>3. MAIN CABLE INSTALLATION</b>	
<b>INSTALLATION D'UN CÂBLE PRINCIPAL</b> .....	<b>9</b>
3.1. PREPARING AND INSTALLING THE CABLE <i>PRÉPARATION ET INSTALLATION DU CÂBLE</i> .....	9
3.2. ROUTING AND SPLICING THE MICROBUNDLES IN THE SPLICING AREA <i>CHEMINEMENT ET ÉPISSURAGE DES MICROMODULES DANS LA ZONE D'ÉPISSURAGE</i> .....	11
<b>4. DROP CABLE INSTALLATION</b>	
<b>INSTALLATION D'UN CÂBLE DE RACCORDEMENT</b> .....	<b>12</b>
<b>5. FERMETURE</b>	
<b>CLOSING</b> .....	<b>13</b>
<b>6. INSTRUCTIONS DE FIN DE VIE</b>	
<b>END LIFE INSTRUCTIONS</b> .....	<b>14</b>
<b>APPENDICES / ANNEXES</b>	
<b>USE OF NFC TAG</b>	
<b>UTILISATION DU TAG NFC</b> .....	<b>15</b>

## 1. OVERVIEW

### DESCRIPTION

#### 1.1. Product presentation *Présentation du produit*

- |     |  |     |  |
|-----|--|-----|--|
| 1-  | Removable cover                              | 1-  | Capot amovible   |
| 2-  | <b>Removable hinges*</b>                     | 2-  | <b>Charnières amovibles*</b>                           |
| 3-  | Closure base                                 | 3-  | Corps du boîtier                                       |
| 4-  | Patching module                              | 4-  | Block de raccordement                                  |
| 5-  | Fixation plate                               | 5-  | Plaque de fixation                                     |
| 6-  | Splicing area                                | 6-  | Zone d'épissurage                                      |
| 7-  | Cables output kit                            | 7-  | Kit de sortie des câbles                               |
| 8-  | Cables input kit                             | 8-  | Kit d'entrée des câbles                                |
| 9-  | <b>Cable preparation and storage system*</b> | 9-  | <b>Système de préparation et de stockage de câble*</b> |
| 10- | Lock (3 types of locks)                      | 10- | Serrure (3 types de serrures)                          |

\*Patent pending  
Demande de brevet en cours

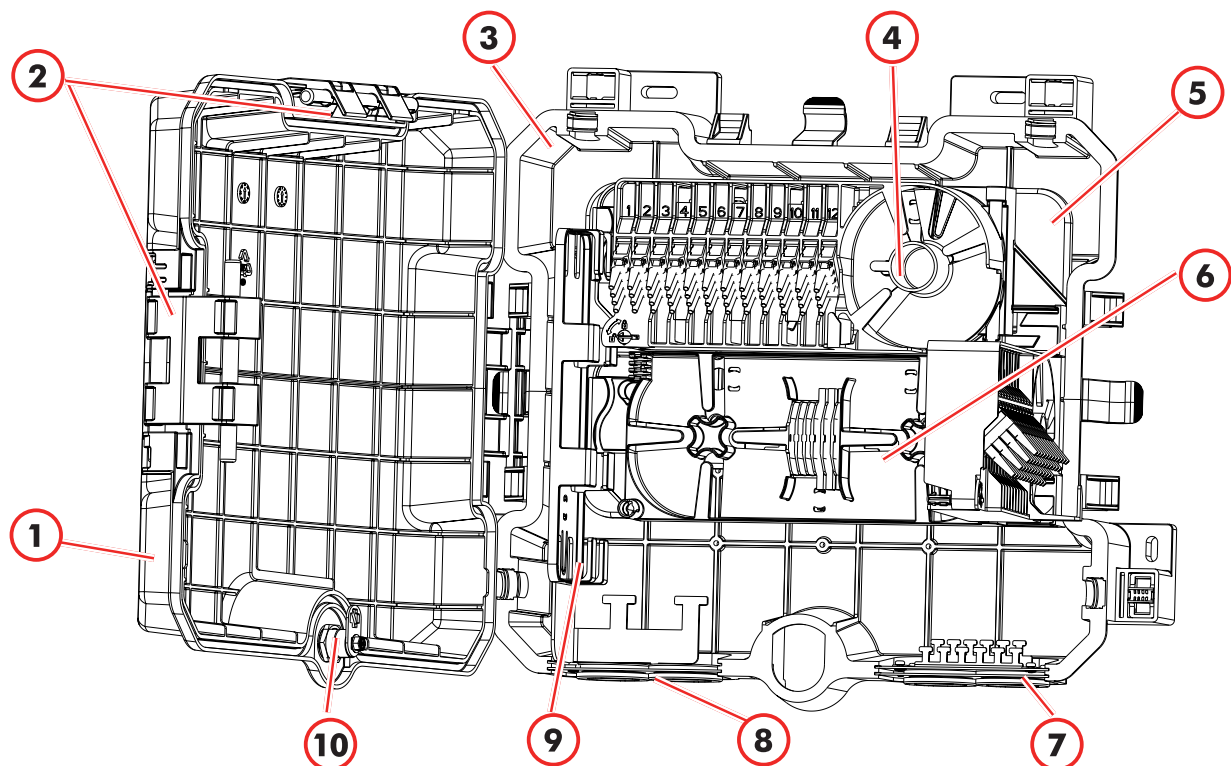

The assembly instructions are identical for the @XS-BOX L and XL. In a desire for simplification, only the @XS-BOX L is represented.

*Les instructions de montage sont identiques pour les @XS-BOX L et XL. Par souci de simplification, seule la @XS-BOX L est représentée.*

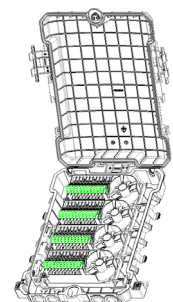

1.2. Dimensional characteristics  
*Caractéristiques dimensionnelles*

- |                |           |                         |           |
|----------------|-----------|-------------------------|-----------|
| - Width:       | 427mm     | - <i>Largeur :</i>      | 427mm     |
| - Height L/XL: | 380/553mm | - <i>Hauteur L/XL :</i> | 380/553mm |
| - Depth:       | 127mm     | - <i>Profondeur :</i>   | 127mm     |

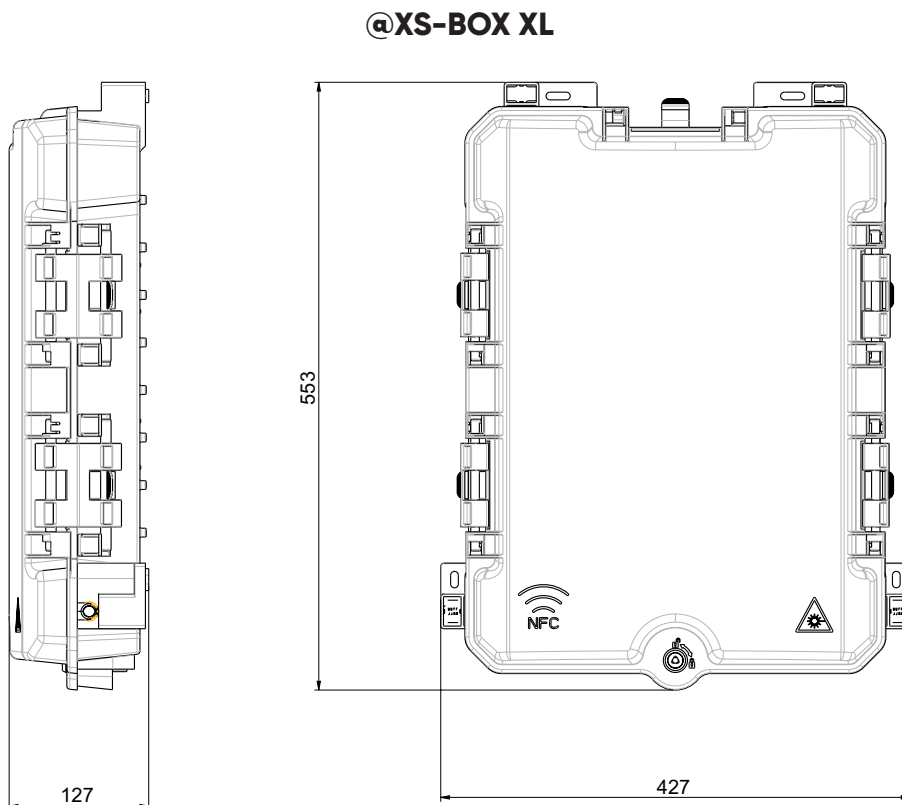
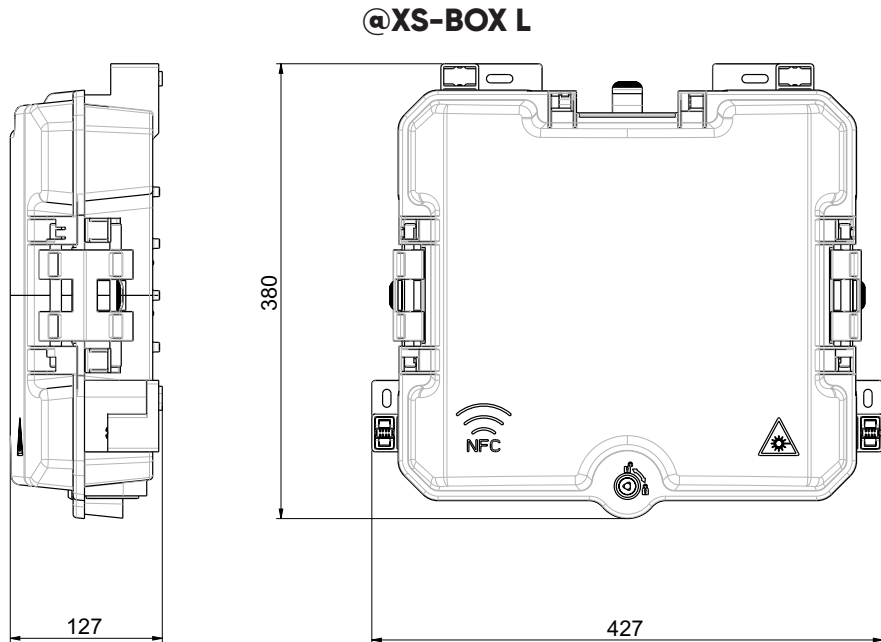

**2. BOX INSTALLATION**  
**INSTALLATION DU BOÎTIER**

2.1. Fixation murale  
*Wall mounting*

- |   |  |
|---|--|
| <ol style="list-style-type: none"> <li>1. Place the box on the wall and trace a mark to facilitate drilling</li> <li>2. Drill the wall and fit the wall anchors supplied</li> <li>3. Secure the box with the screws supplied</li> </ol> | <ol style="list-style-type: none"> <li>1. Placer le boîtier sur le mur et tracer un repère pour faciliter le perçage</li> <li>2. Percer le mur et installer les chevilles fournies</li> <li>3. Fixer le boîtier avec les vis fournies</li> </ol> |
|---|--|

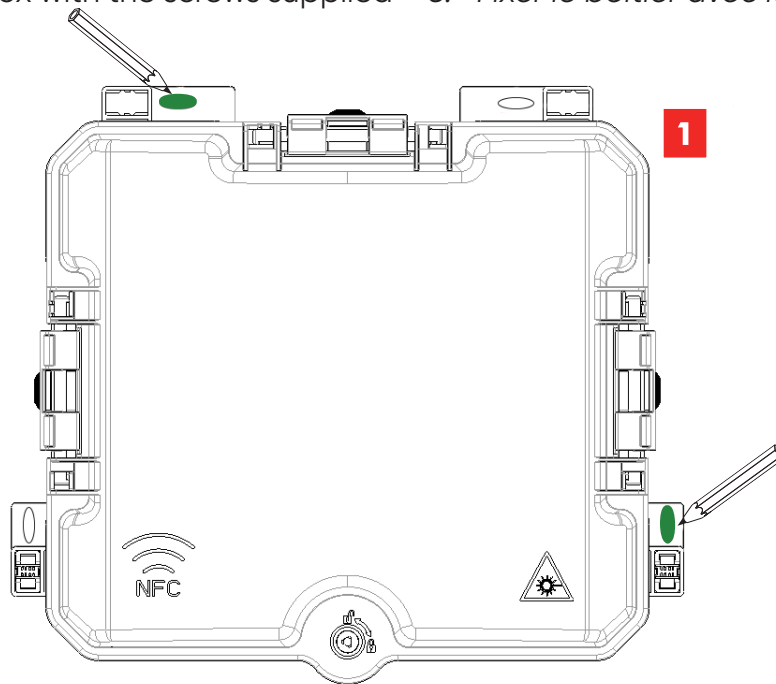

**Only 2 screws are needed, preferring diagonal fixing as shown in the diagram above.**

**Seul 2 vis suffisent, préférer une fixation en diagonale comme indiqué sur le schéma ci-dessus.**

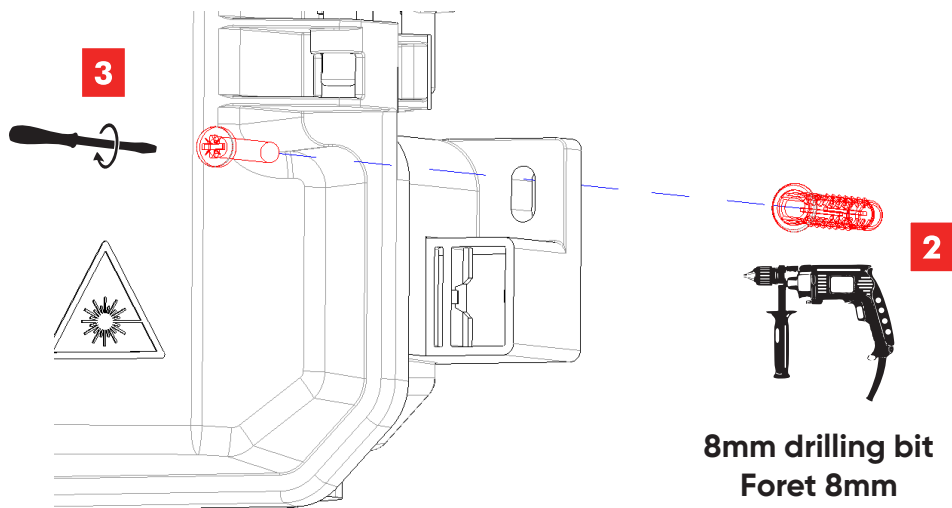

2.2. Opening  
Ouverture

1. Unlock according to the option used

1. Déverrouiller en fonction de l'option utilisée

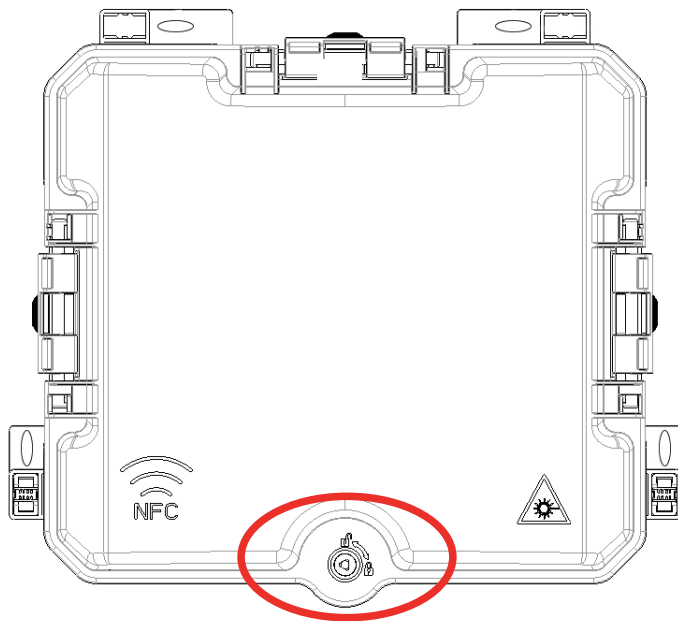

NFC lock

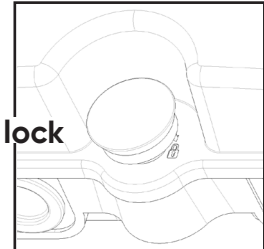

Standard lock

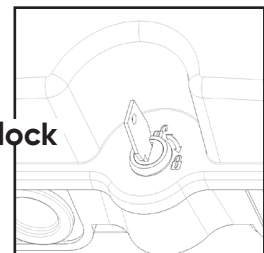

Triangular lock

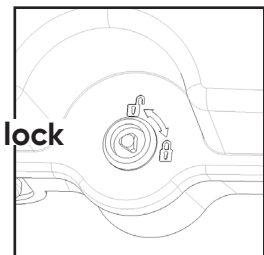

Procedure for changing the box lock

- A. Remove the cover
- B. Unscrew the nut and the cam
- C. Loosen nut and remove lock
- D. Take the new lock
- E. Replace nut + cam + nut

Mode opératoire pour changer la serrure du boîtier

- A. Démontez le capot
- B. Dévissez l'écrou et la came
- C. Desserrer l'écrou et retirer la serrure
- D. Prendre la nouvelle serrure
- E. Remettre écrou + came + écrou

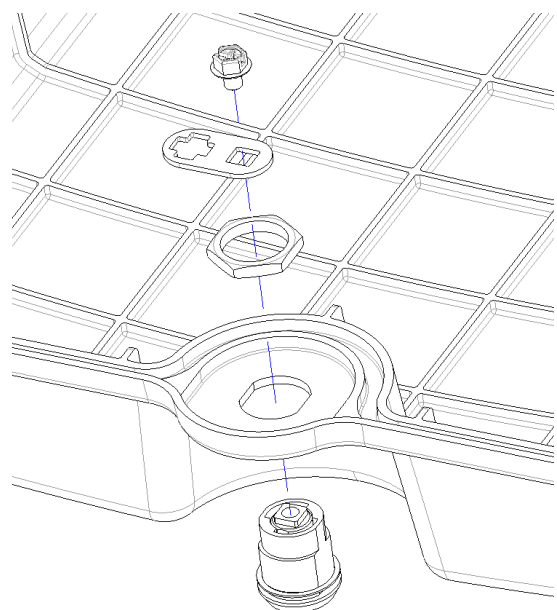

2. Opening the box to the sides or upwards depending on installation configuration

2. Ouverture du boîtier sur les côtés ou vers le haut selon la configuration d'installation

**Side opening**  
**Ouverture côté**

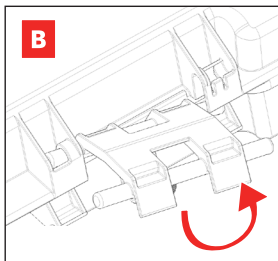
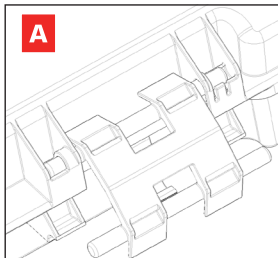
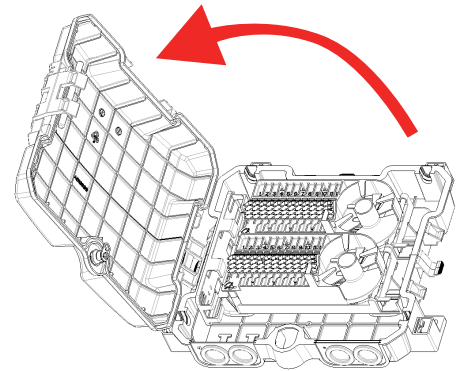
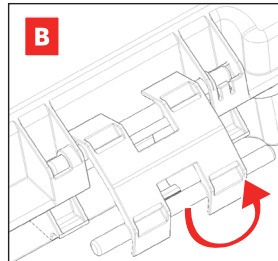
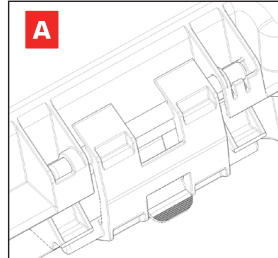
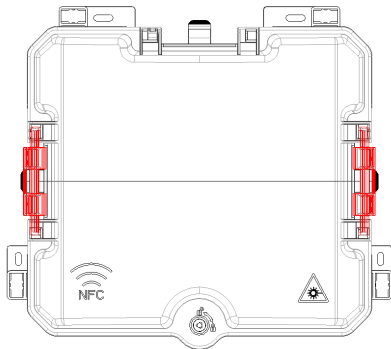

**Upward opening**  
**Ouverture vers le haut**

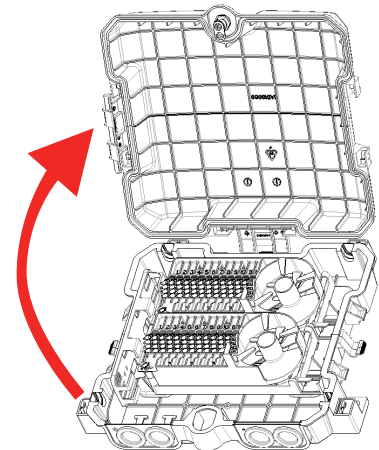
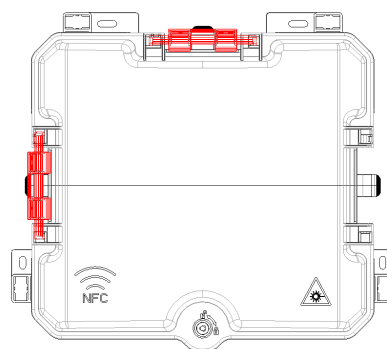

2.3. Configurations  
Configurations

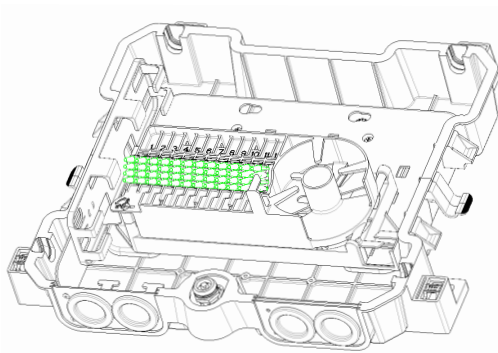

24 SC / 48 LC

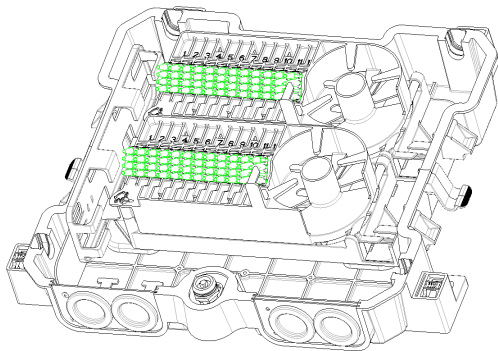

48 SC / 96 LC

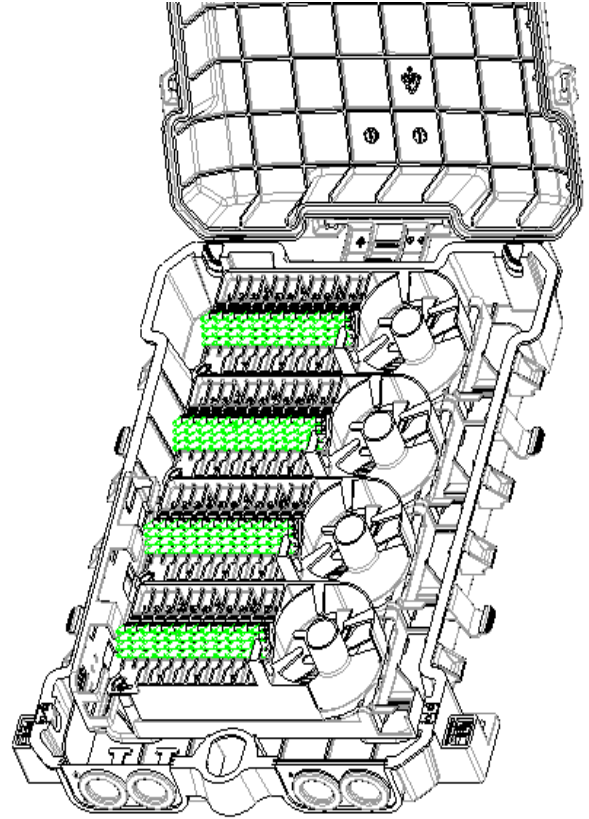

96 SC / 192 LC

 *Module installation*

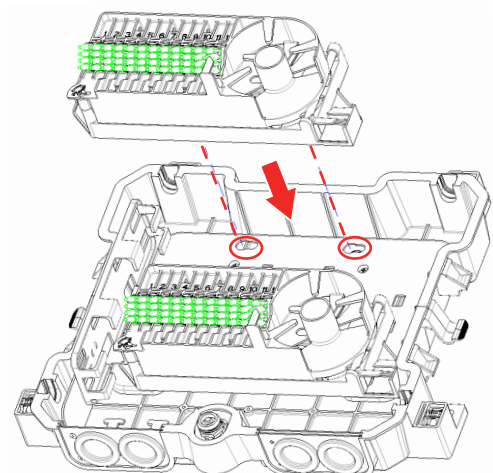

*Installation d'un block*

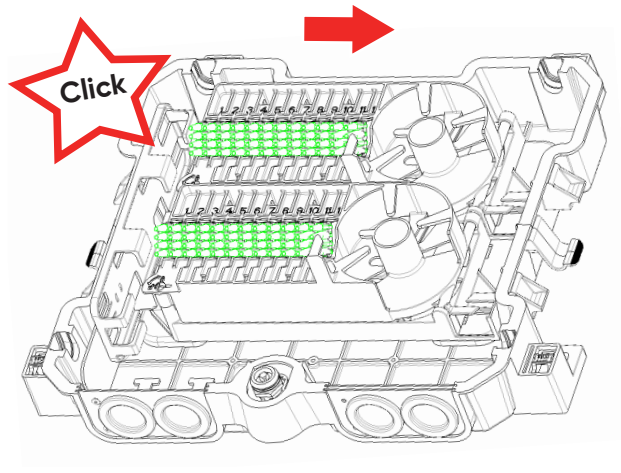



### 3. MAIN CABLE INSTALLATION INSTALLATION D'UN CÂBLE PRINCIPAL

#### 3.1. Preparing and installing the cable Préparation et installation du câble

- |  |  |
|--|--|
| <ol style="list-style-type: none"> <li>1. <i>Preparing the cable</i></li> <li>2. Remove <b>cable preparation and storage system*</b></li> <li>3. <i>Cut the seal (make a cross with a cutter)</i></li> <li>4. <i>Pass the cable through the seal and secure it with a tie</i></li> <li>5. Reinstall the <b>cable preparation and storage system*</b> in the box</li> </ol> | <ol style="list-style-type: none"> <li>1. Préparation du câble</li> <li>2. Sortir <b>système de préparation et de stockage de câble*</b></li> <li>3. Percer le joint (faire une croix avec un couteur)</li> <li>4. Passer le câble dans le joint et l'arrimer avec un collier</li> <li>5. Reinstaller le <b>système de préparation et de stockage de câble*</b> dans le boîtier</li> </ol> |
|--|--|

\*Patent pending  
Demande de brevet en cours

**1**

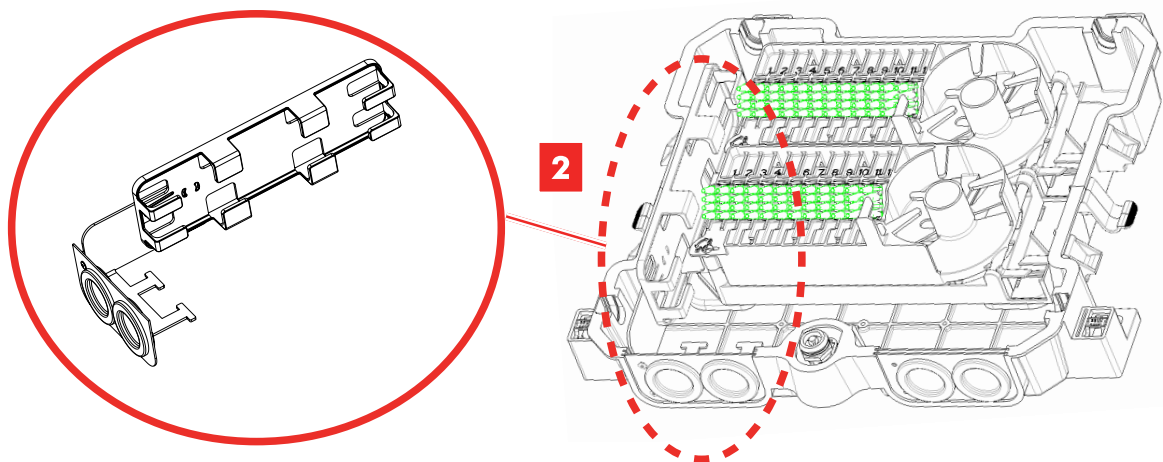
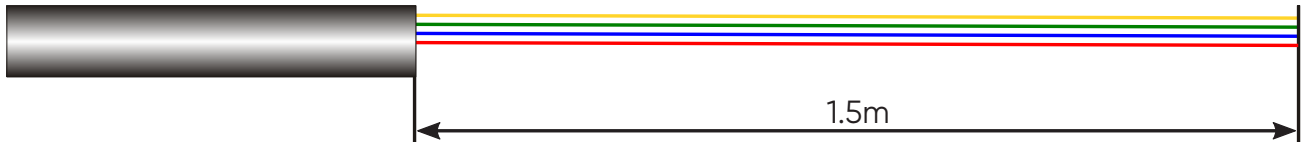

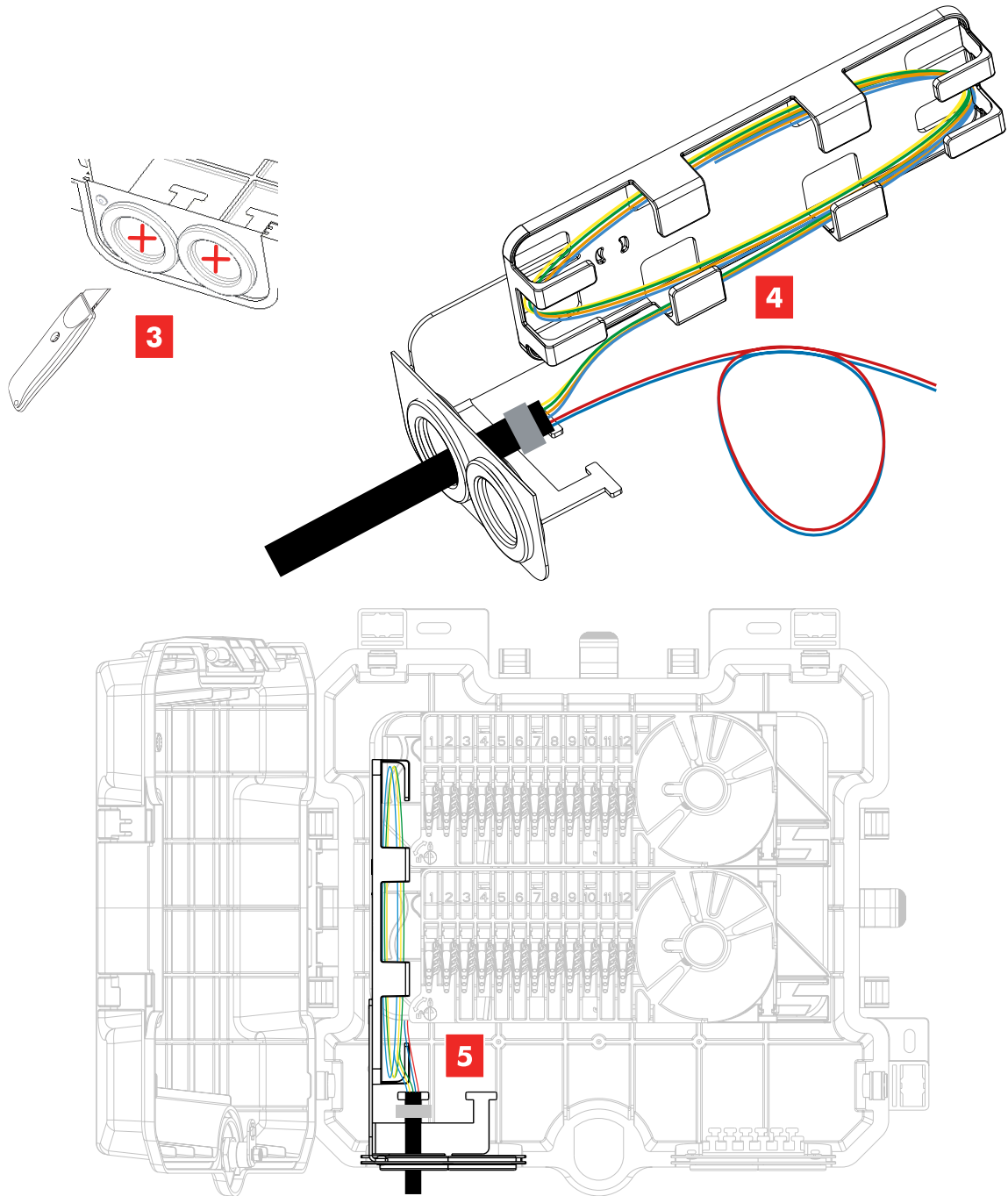

3.2. Routing and splicing the microbundles in the splicing area  
*Cheminement et épissure des micromodules dans la zone d'épissure*

- |  |  |
|--|--|
| 1. Unlock the patch panels                       | 1. Déverrouillage des panneaux de brassage               |
| 2. Routing the microbundles in the splicing area | 2. Acheminement des micromodules dans la zone d'épissure |
| 3. Splicing the fibre to the splitter input      | 3. Epissure la fibre au tronc du coupleur                |
| 4. Locking the patch panels                      | 4. Verrouillage des panneaux de brassage                 |

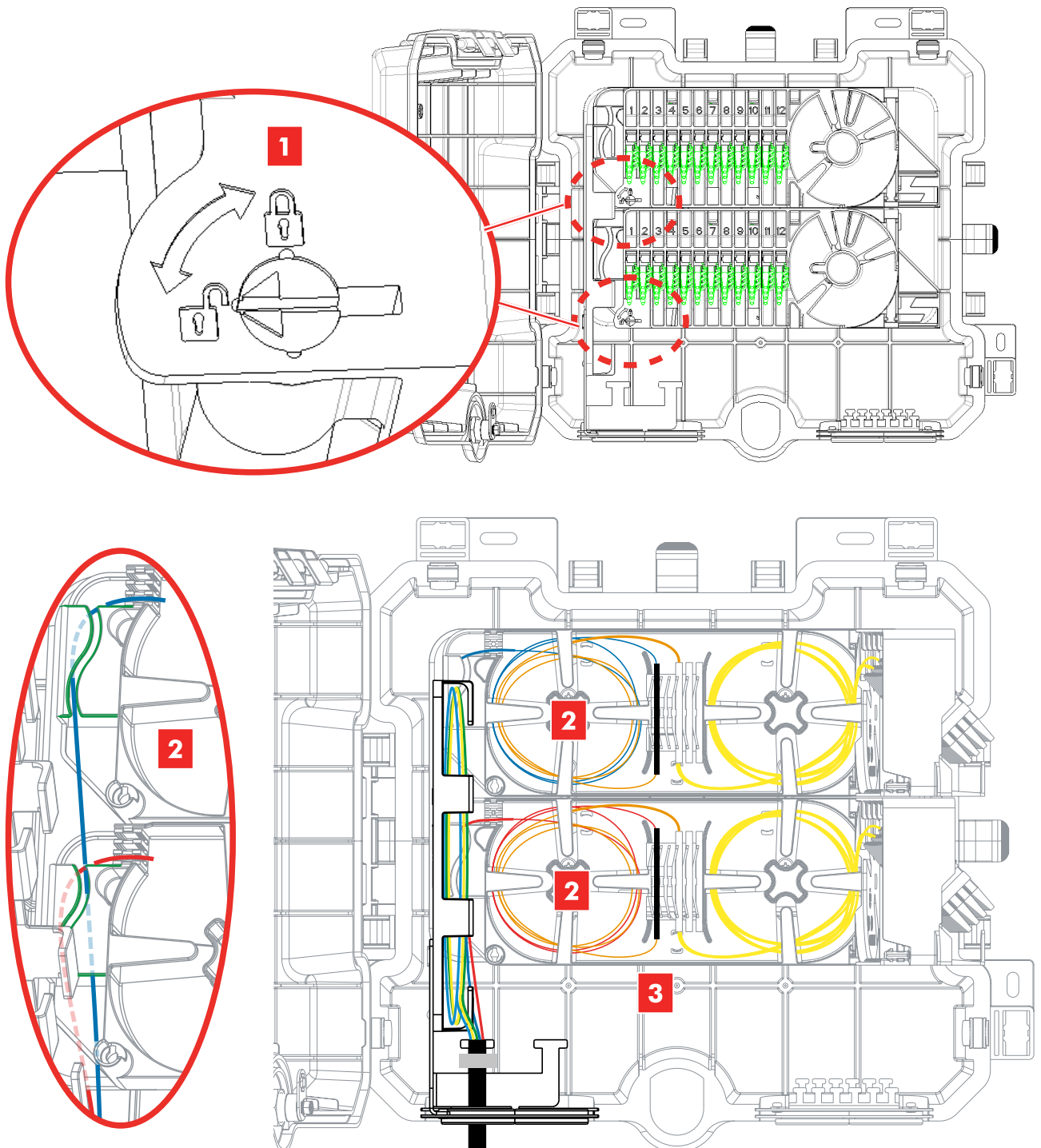

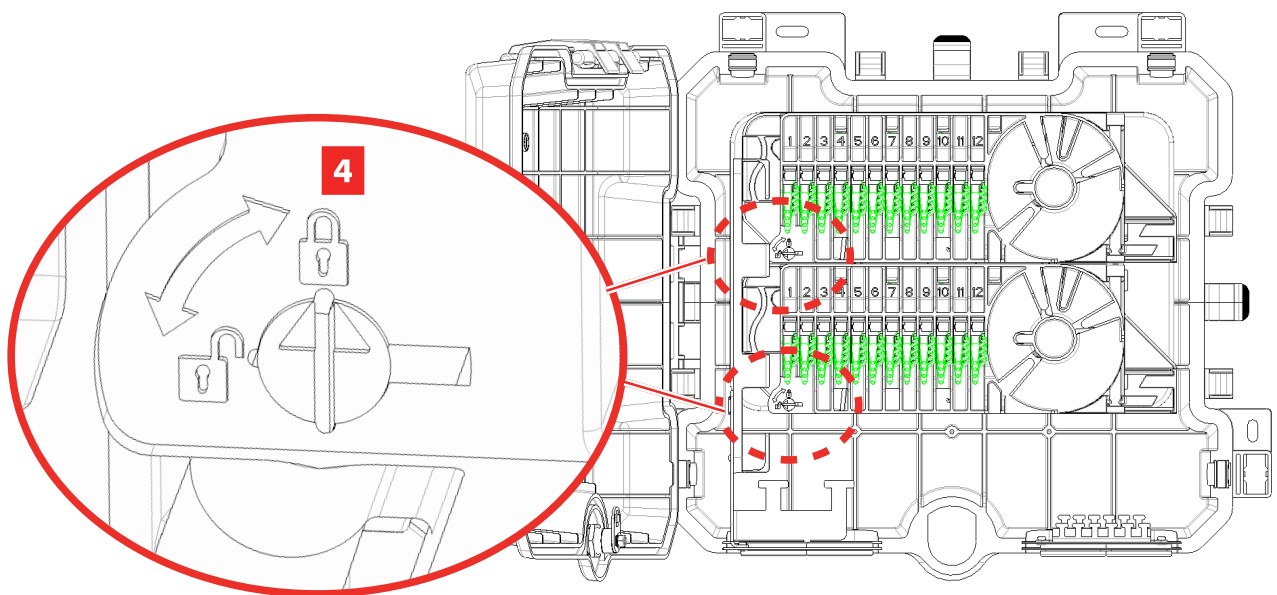

**4. DROP CABLE INSTALLATION  
INSTALLATION D'UN CÂBLE DE RACCORDEMENT**

- |   |   |
|---|---|
| <ol style="list-style-type: none"> <li>1. Cut the seal (make a cross with a cutter)</li> <li>2. Pass the cable and clamp it with a plastic tie</li> <li>3. Connect the patchcords to the patch panel</li> <li>4. Put the overlength to the coiling area if necessary</li> </ol> | <ol style="list-style-type: none"> <li>1. Percer le joint (faire une croix avec un couteur)</li> <li>2. Passer le câble et arrimer le avec un collier plastique</li> <li>3. Raccorder les cordons sur le panneau de brassage</li> <li>4. Ramener les sur longueurs dans le tambour de lovage si nécessaire</li> </ol> |
|---|---|

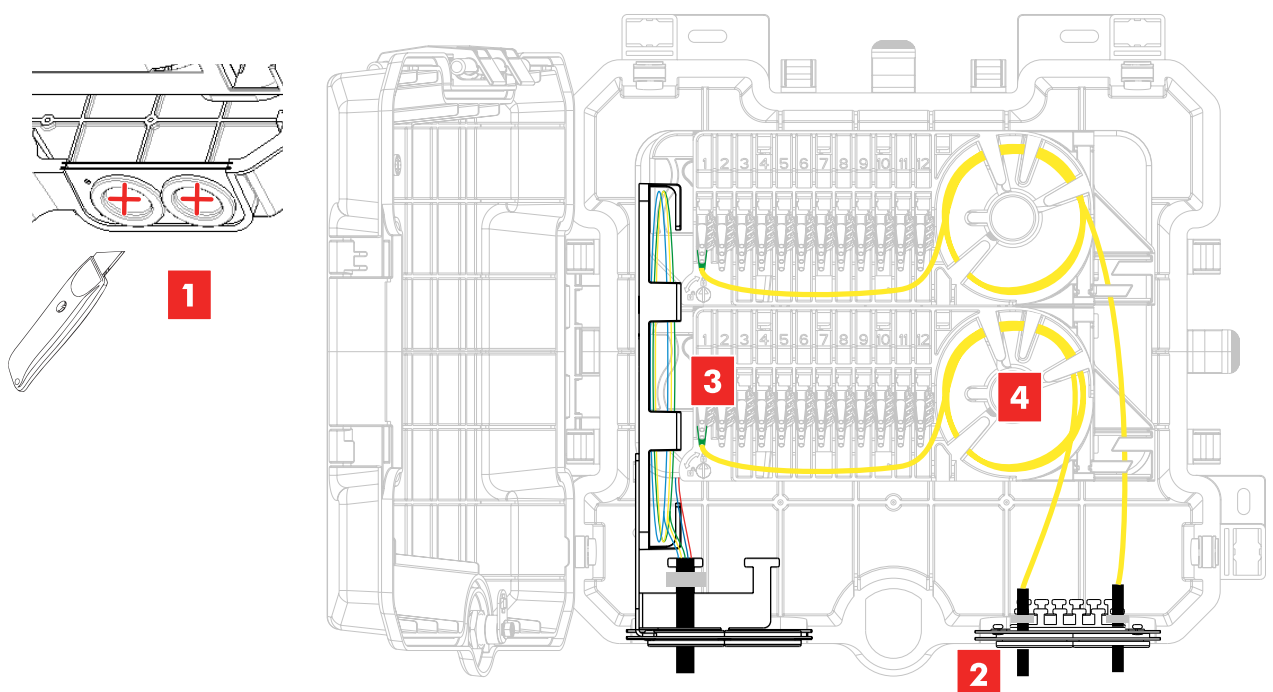

**5. FERMETURE  
CLOSING**

1. Fermer le capot et la **charnières amovibles\***

1. Close the cover and the **removable hinges\***

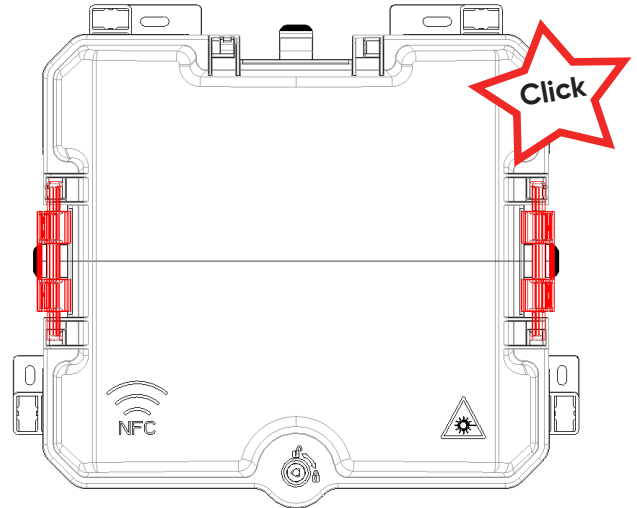
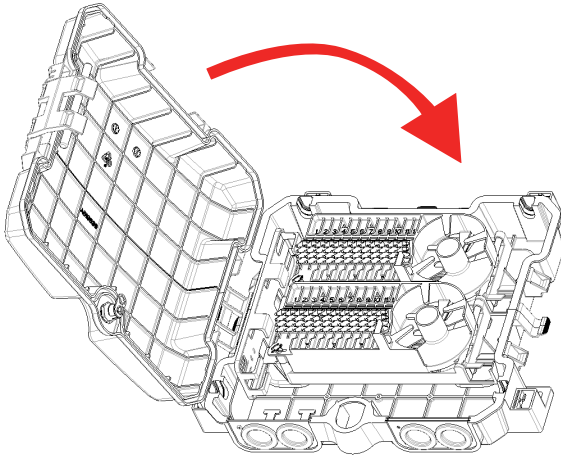

\*Patent pending  
Demande de brevet en cours

2. Lock according to the option used

2. Verrouiller selon l'option utilisée

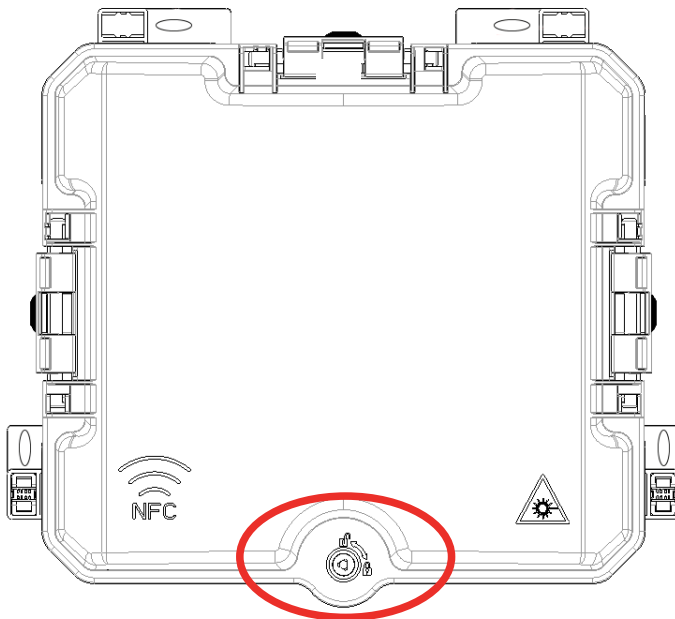

**NFC lock**

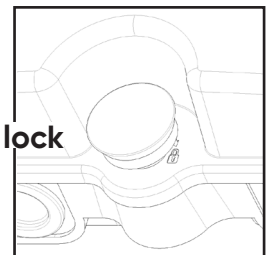

**Standard lock**

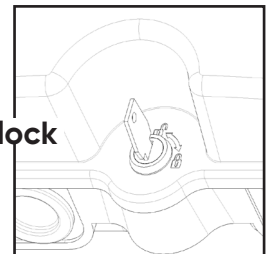

**Triangular lock**

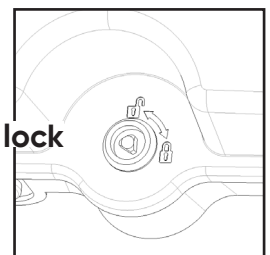

6. INSTRUCTIONS DE FIN DE VIE  
END LIFE INSTRUCTIONS

	 Emballage carton, sachet plastique <i>Cardboard, plastic packaging</i>	 Sachet zip réutilisable <i>Reusable zip bag</i>
	 Pièce métallique et plastique <i>Metal and plastic component</i>	<b>WEEE / DEEE</b>  Équipement électrique et électronique <i>Electrical and electronic equipment</i>

## ANNEXES / APPENDICES

### USE OF NFC TAG UTILISATION DU TAG NFC

Use the NFC tag to have an access to the documentation

*Utiliser le tag NFC pour accéder à la documentation*

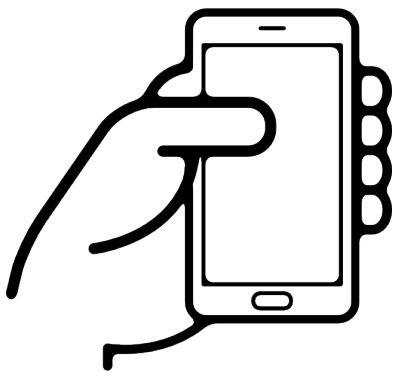

**Connect via LinkedIn**  
Se connecter via LinkedIn



*Learn more on YouTube* En savoir plus sur Youtube

*Visit [www.aginode.net](http://www.aginode.net)*  
Visiter [www.aginode.net](http://www.aginode.net)

Contact us via  
Contactez-nous via  
[info@aginode.net](mailto:info@aginode.net)

AGINODE  
25, avenue Jean Jaurès  
08330 Vrigne-aux-Bois  
FRANCE  
Tel. +33 (0) 3 24 52 61 61

