

Document : ABS1549/D
Date : 15/03/2024



#smartconnection

NOTICE / INSTRUCTIONS



@XS-BOX M

Boîtier d'étage épissure et brassage
Floor box splicing and patching

www.aginode.net



Table des matières

Table of contents

1. DESCRIPTION	
OVERVIEW	3
1.1. PRÉSENTATION DU PRODUIT	
PRODUCT PRESENTATION	3
1.2. ACCESSOIRES FOURNIS (SELON CONFIGURATION)	
PROVIDED ACCESSORIES (ACCORDING TO CONFIGURATION).....	4
2. FIXATION MURALE	
WALL MOUNTING	5
3. OPÉRATIONS PRÉLIMINAIRES	
PRELIMINARY OPERATIONS	6
3.1. ACCÈS AU BOÎTIER	
ACCESSING THE BOX.....	6
3.2. MONTAGE DES PEIGNES ET DES SUPPORTS ANT	
MOUNTING THE COMBS AND ANT HOLDERS.....	6
3.3. MISE EN PLACE DES RACCORDS	
ADAPTERS INSTALLATION.....	7
4. INSTALLATION DU CÂBLE COLONNE MONTANTE	
MOUNTING THE RISER CABLE	8
4.1. CÂBLE COLONNE MONTANTE PRÉCONNECTORISÉ	
PRETERMINATED RISER CABLE	8
4.2. CÂBLE COLONNE MONTANTE ÉPISSURÉ SUR PIGTAILS	
RISER CABLE SPLICED ON PIGTAILS.....	9
5. RACCORDEMENT DES ABONNÉS	
SUBSCRIBERS CONNECTION	12
5.1. CÂBLES ABONNÉS PRÉCONNECTORISÉS	
PRETERMINATED SUBSCRIBER CABLES.....	12
5.2. CÂBLES ABONNÉS ÉPISSURÉS SUR PIGTAILS	
SUBSCRIBER CABLES SPLICED ON PIGTAILS	13
6. FERMETURE DU BOÎTIER	
BOX CLOSING	15
6.1. BOÎTIER INSTALLÉ SANS JUPES	
BOX INSTALLATION WITHOUT EXTENSION COVERS	15
6.2. BOÎTIER INSTALLÉ AVEC JUPES	
BOX INSTALLATION WITH EXTENSION COVERS	15
7. SÉCURISATION DU BOÎTIER	
BOX SECURISATION	16
8. INSTRUCTIONS DE FIN DE VIE	
END LIFE INSTRUCTIONS	17

**1. DESCRIPTION
OVERVIEW**

1.1. Présentation du produit
Product presentation

- | | |
|---|---|
| <ul style="list-style-type: none"> 1- Corps 2- Capot avec verrou 3- Panneau de brassage pour raccords SC ou LC Duplex 4- 2 supports d'épissures ANT pour 12 épissures chacun (en kit) 5- 1ou 2 cassette(s) d'épissurage 6- Zone de lovage des fibres 7- 2 joints d'étanchéité pour les câbles abonnés (en kit) 8- 2 joints d'étanchéité pour le câble colonne montante (en kit) | <ul style="list-style-type: none"> 1- Base 2- Cover with safety lock 3- Patch panel for SC or LC Duplex adapters 4- 2 ANT splice holders for 12 splices each (delivered in kit) 5- 1 or 2 splice cassette(s) 6- Coiling area for the fibres 7- 2 rubber seals for the subscriber cables (delivered in kit) 8- 2 rubber seals for the riser cable (delivered in kit) |
|---|---|

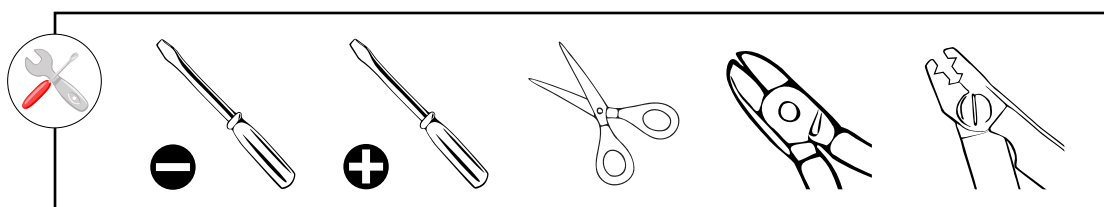
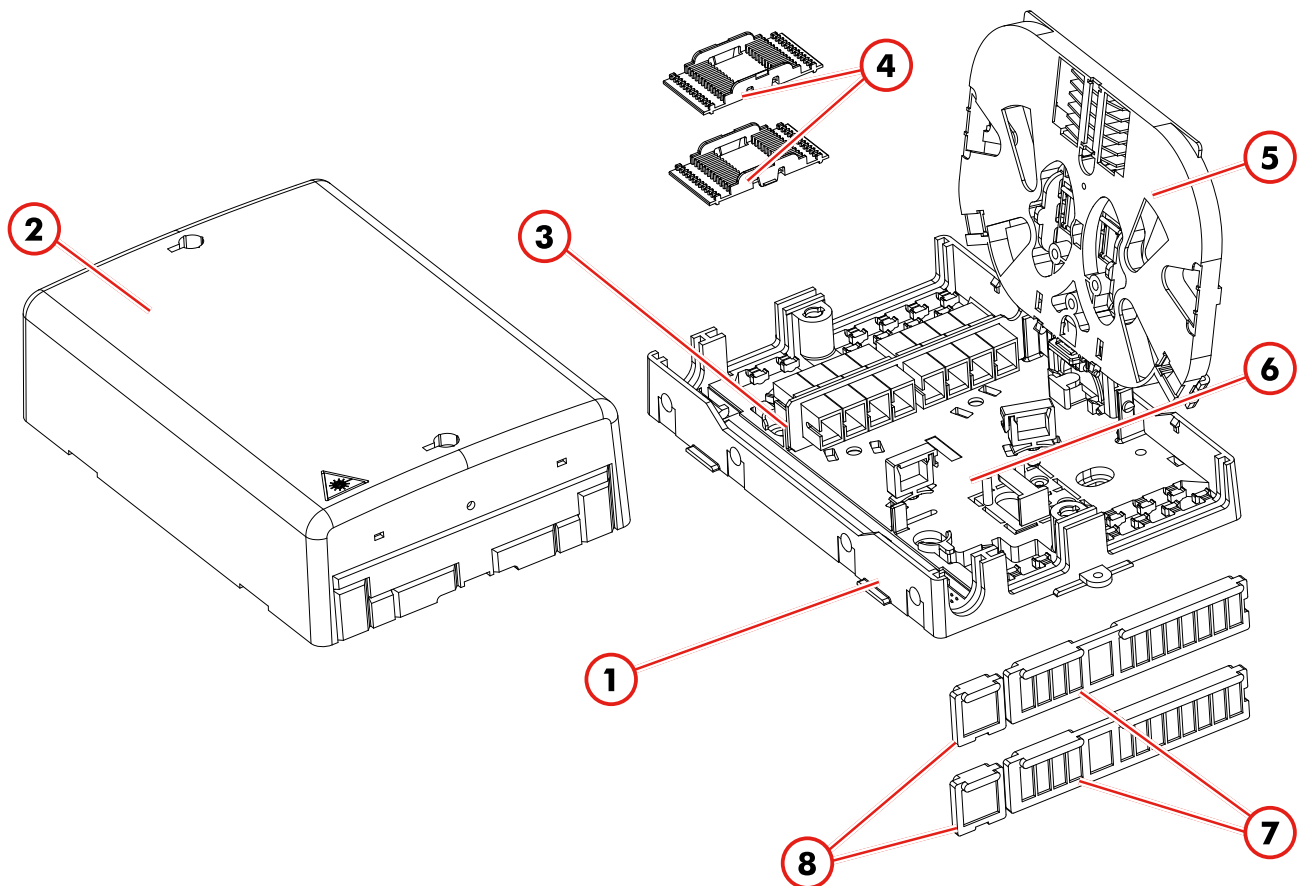

1.2. Accessoires fournis (selon configuration)
Provided accessories (according to configuration)



2 vis de blocage des porteurs
2 screws for strength members fastening

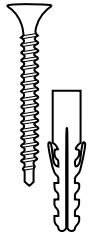

4 vis et chevilles de fixation
4 fixation screws and plugs

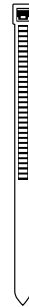

4 colliers plastique T18
4 plastic ties T18



4 colliers plastique T30
4 plastic ties T30

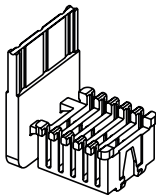

Peigne n° 12
Comb no 12

<i>i</i>	Capacité max. :	<i>Max. capacity:</i>
	25 pigtails \varnothing 0,9-1,1 mm	25 pigtails \varnothing 0.9-1.1mm

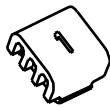

Peigne n° 1
Comb no 1

<i>i</i>	Capacité max. :	<i>Max. capacity:</i>
	6 x \varnothing 1,6 mm	6x \varnothing 1.6mm



Peigne n° 2
Comb no 2

<i>i</i>	Capacité max. :	<i>Max. capacity:</i>
	2 x \varnothing 2,4 mm	2x \varnothing 2.4mm



Peigne n° 3
Comb no 3

<i>i</i>	Capacité max. :	<i>Max. capacity:</i>
	2 x \varnothing 2,8 mm	2x \varnothing 2.8mm

2. FIXATION MURALE WALL MOUNTING



Choisir l'orientation en fonction du cheminement du câble colonne montante.

Choose the position best fitting the riser cable route.

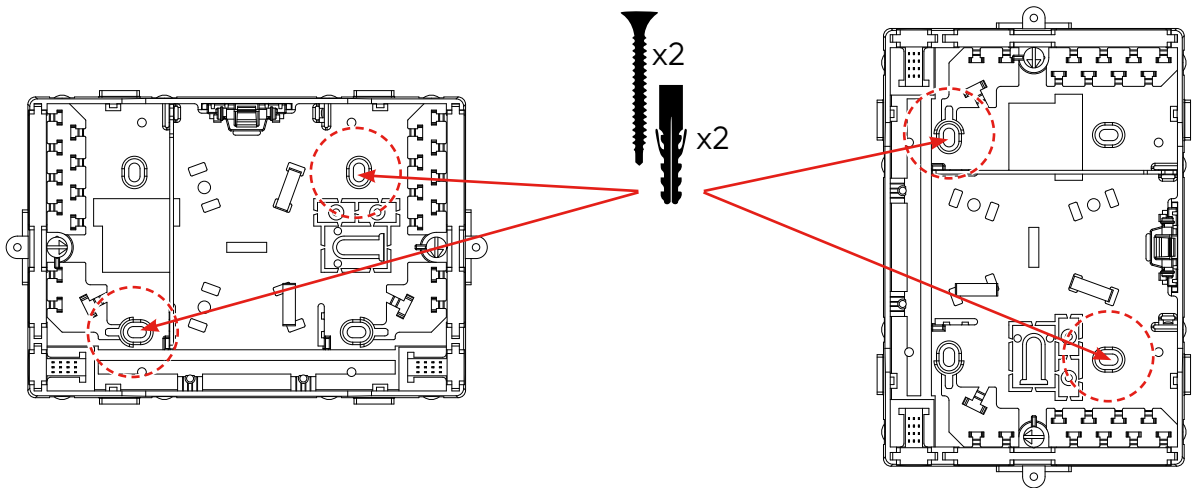
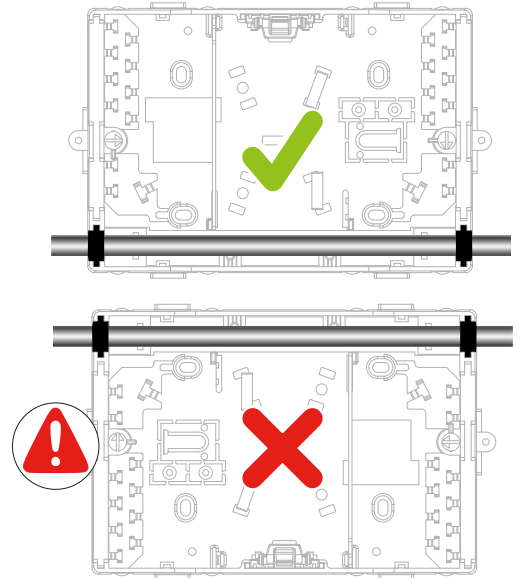
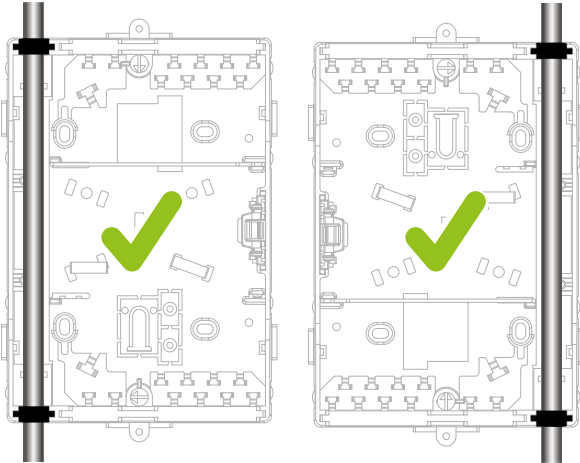

3. OPÉRATIONS PRÉLIMINAIRES PRELIMINARY OPERATIONS

3.1. Accès au boîtier Accessing the box

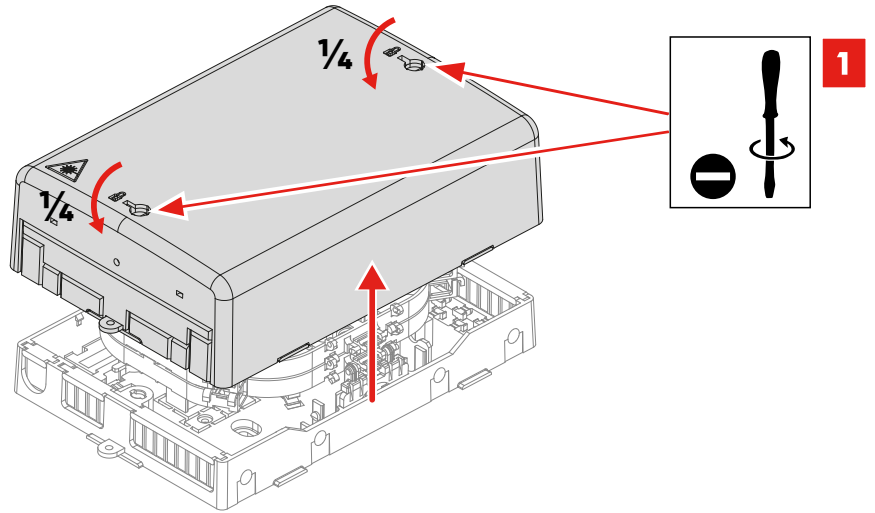

3.2. Montage des peignes et des supports ANT Mounting the combs and ANT holders

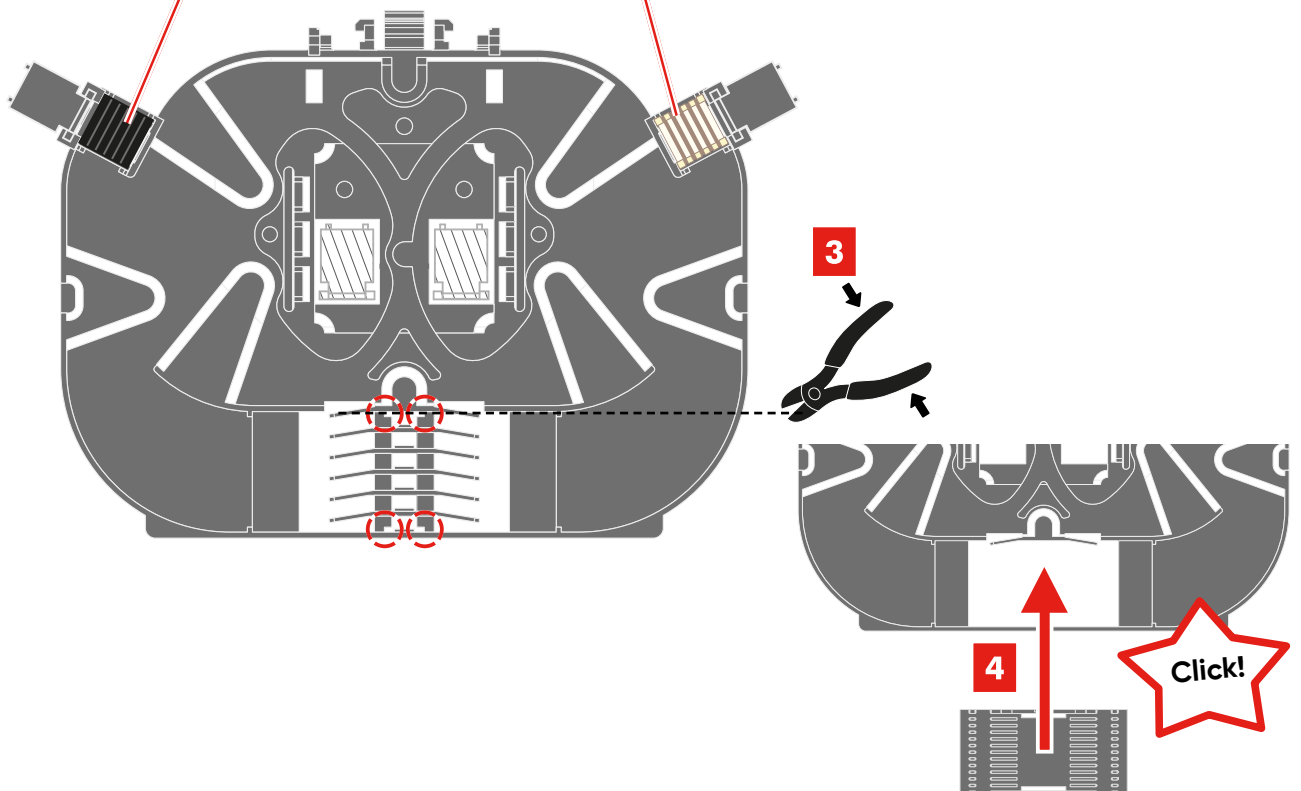
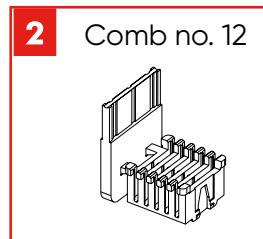
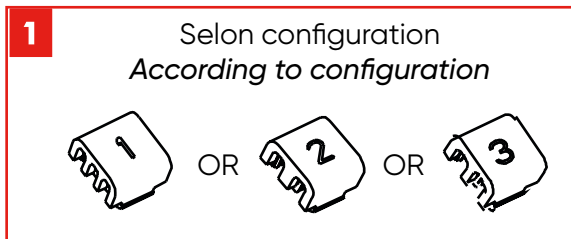

3.3. Mise en place des raccords
Adapters installation

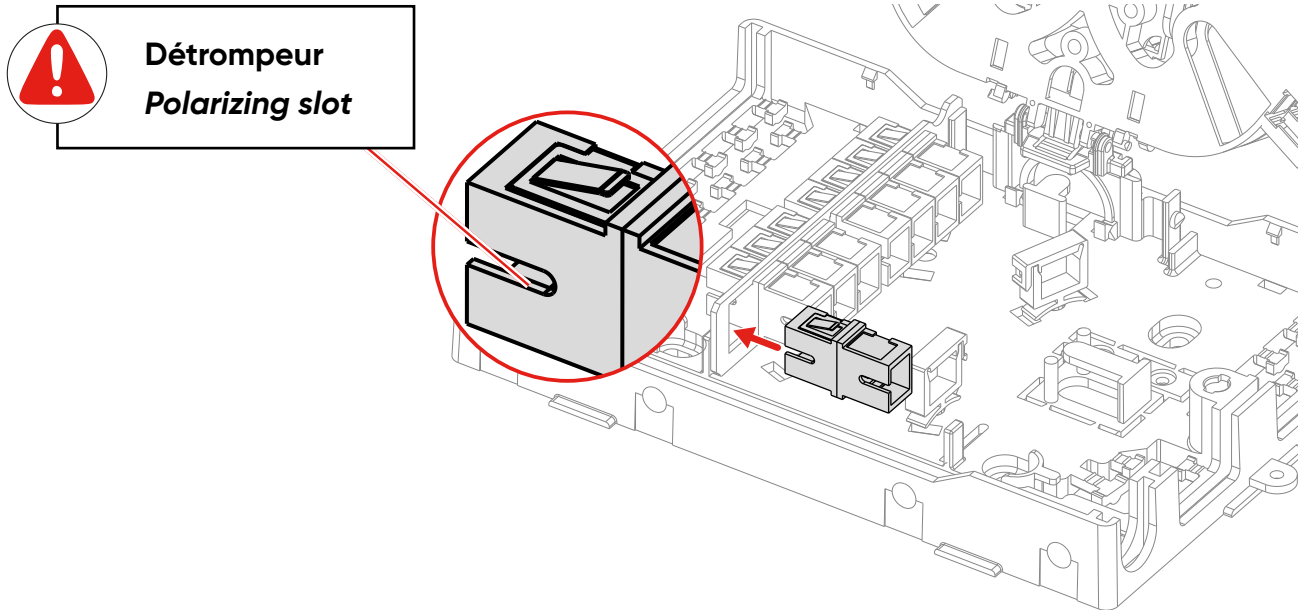

4. INSTALLATION DU CÂBLE COLONNE MONTANTE MOUNTING THE RISER CABLE

4.1. Câble colonne montante préconnectorisé Preterminated riser cable

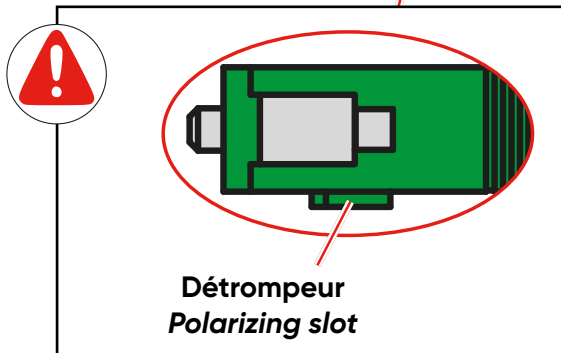
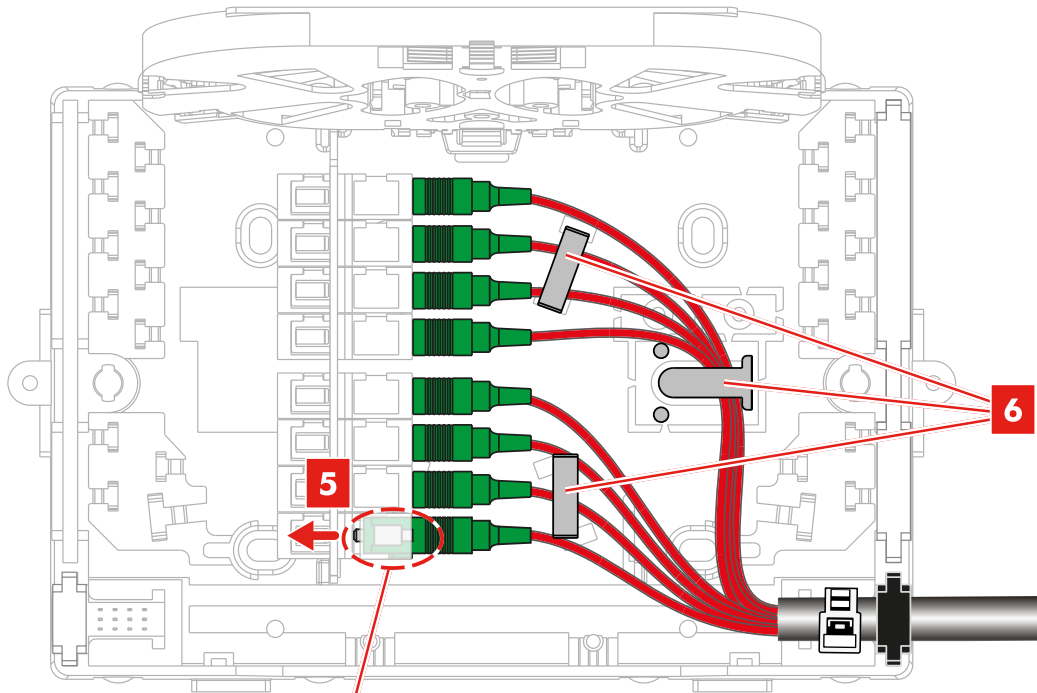
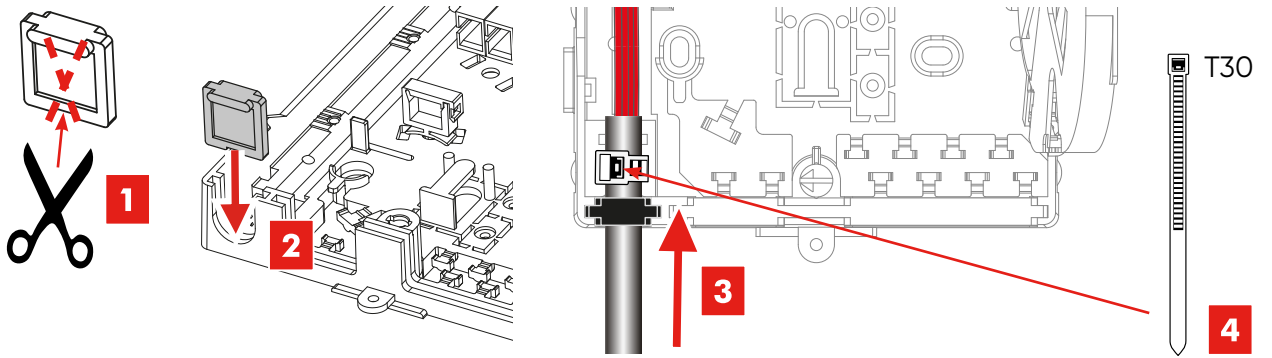

4.2. Câble colonne montante épissuré sur pigtaills
Riser cable spliced on pigtaills

4.2.1. Mise en place des pigtaills
Pigtails installation

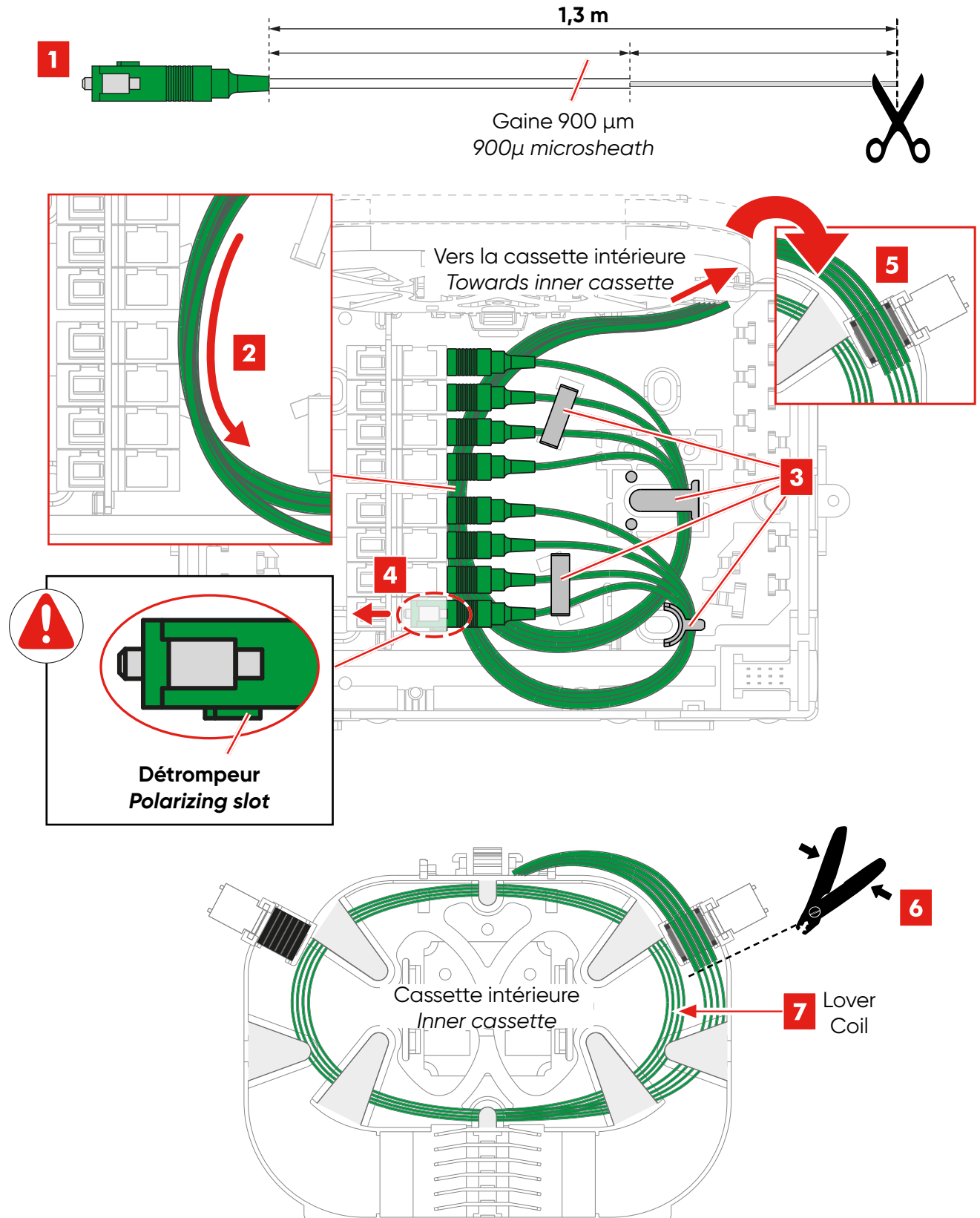

4.2.2. Mise en place du câble colonne montante
Riser cable installation

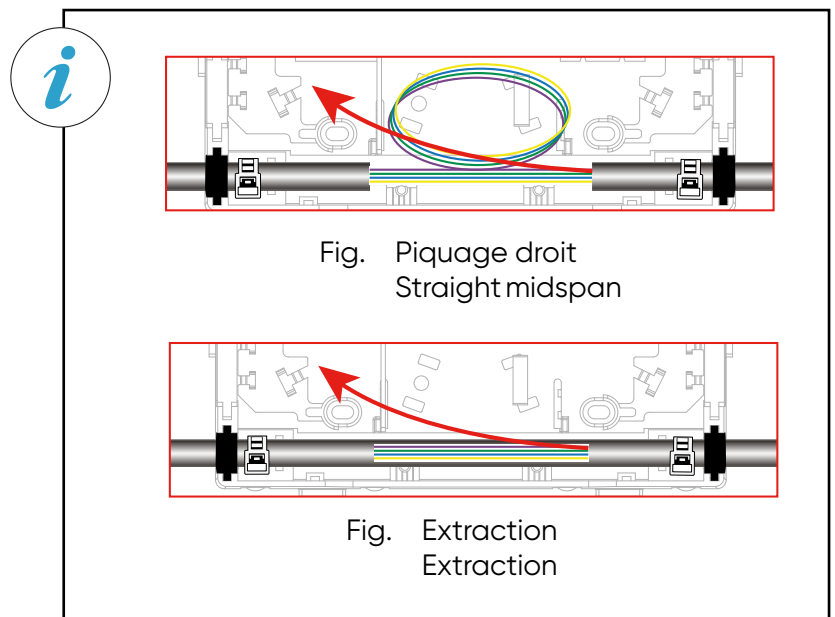
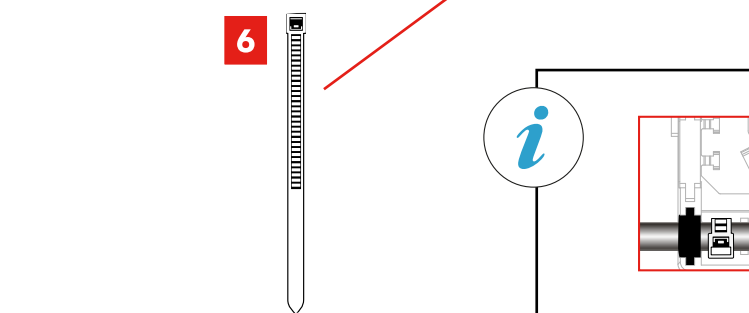
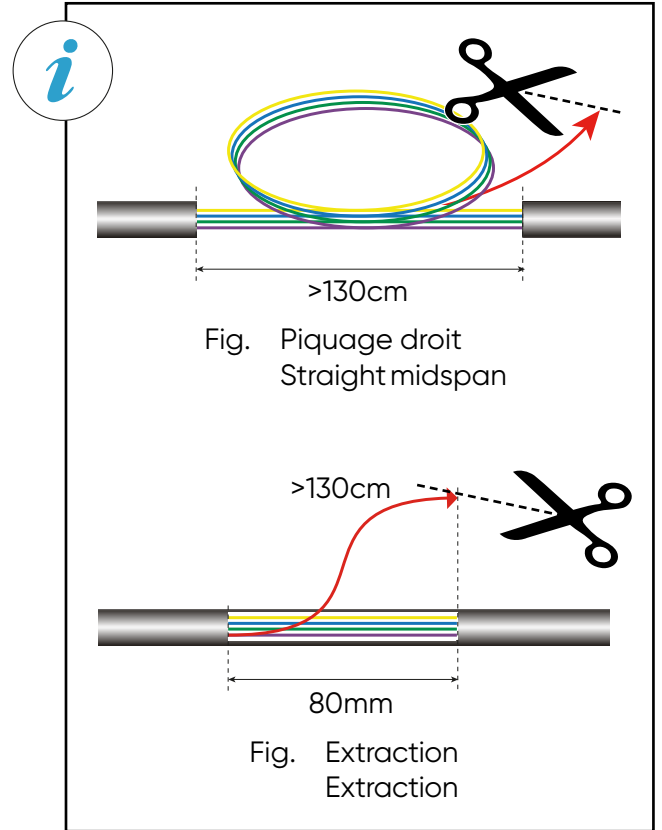
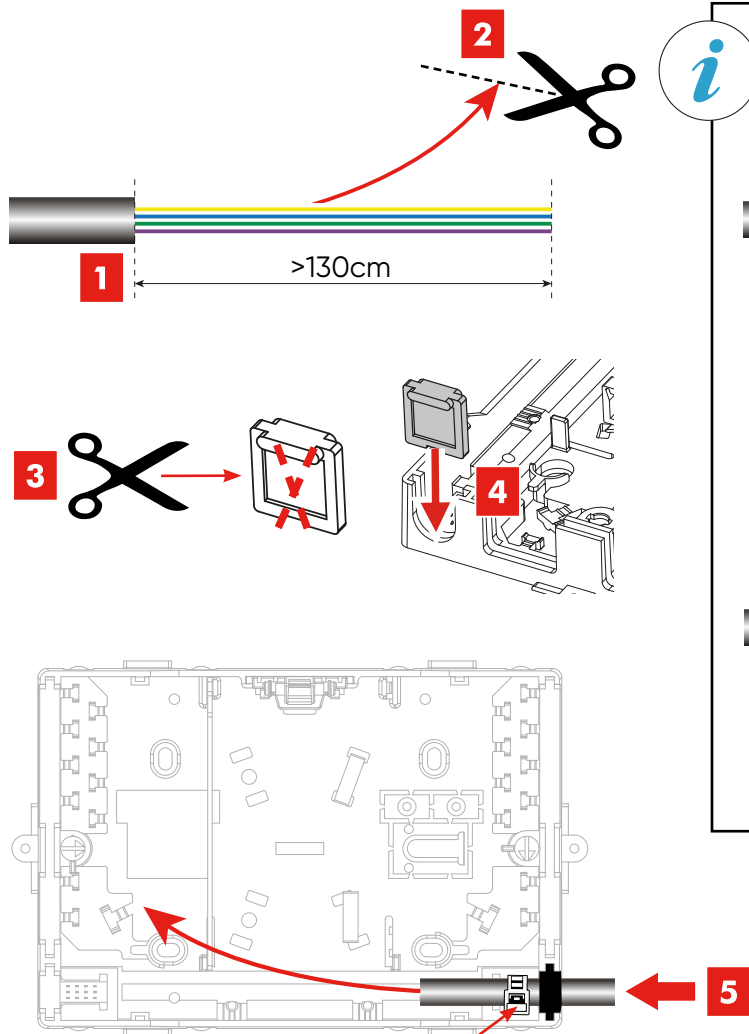

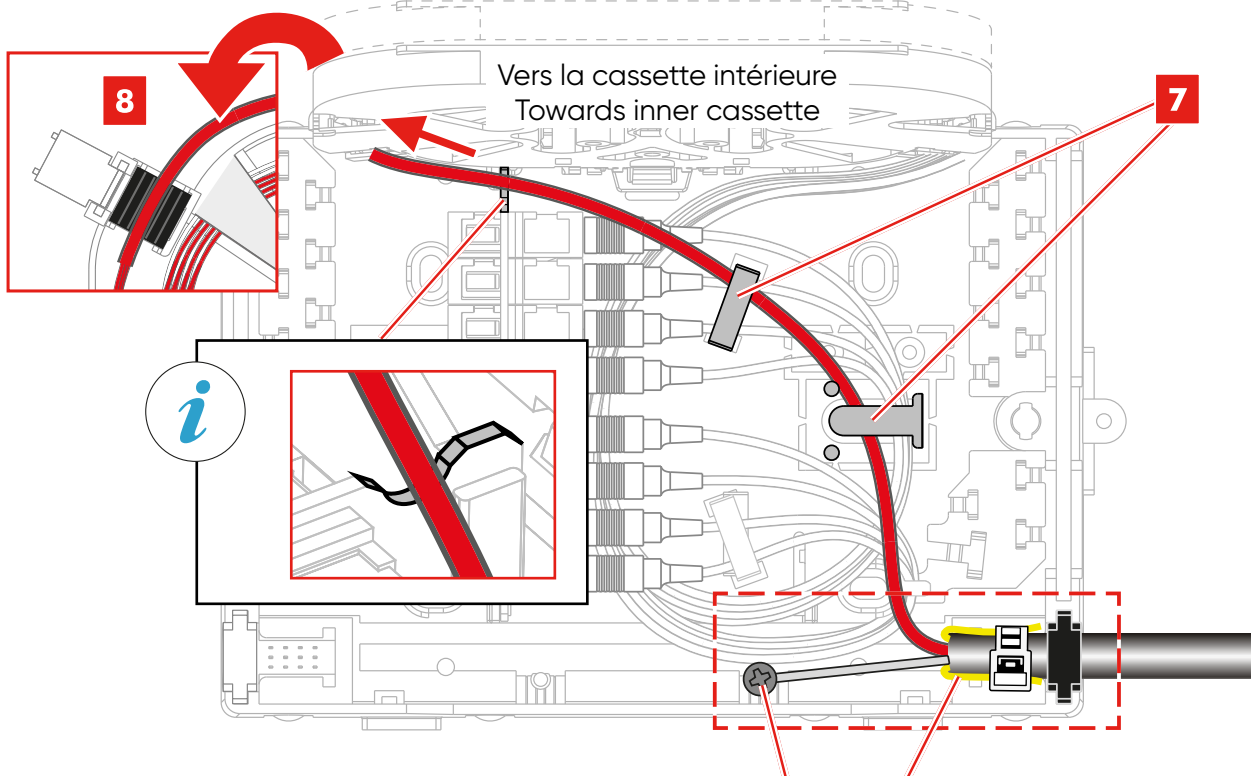

Bloquer le porteur sous la vis fournie.
Bloquer les mèches aramidés sous le collier plastique.



Block the strength member under the screw provided.
Fasten the aramid yarns under the plastic collar.

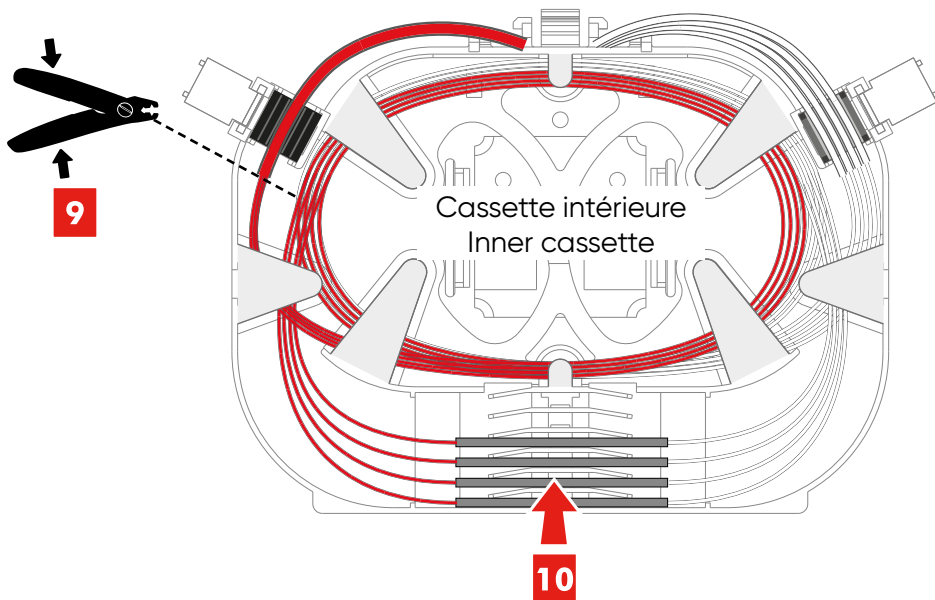

5. RACCORDEMENT DES ABONNÉS SUBSCRIBERS CONNECTION

5.1. Câbles abonnés préconnectorisés Preterminated subscriber cables

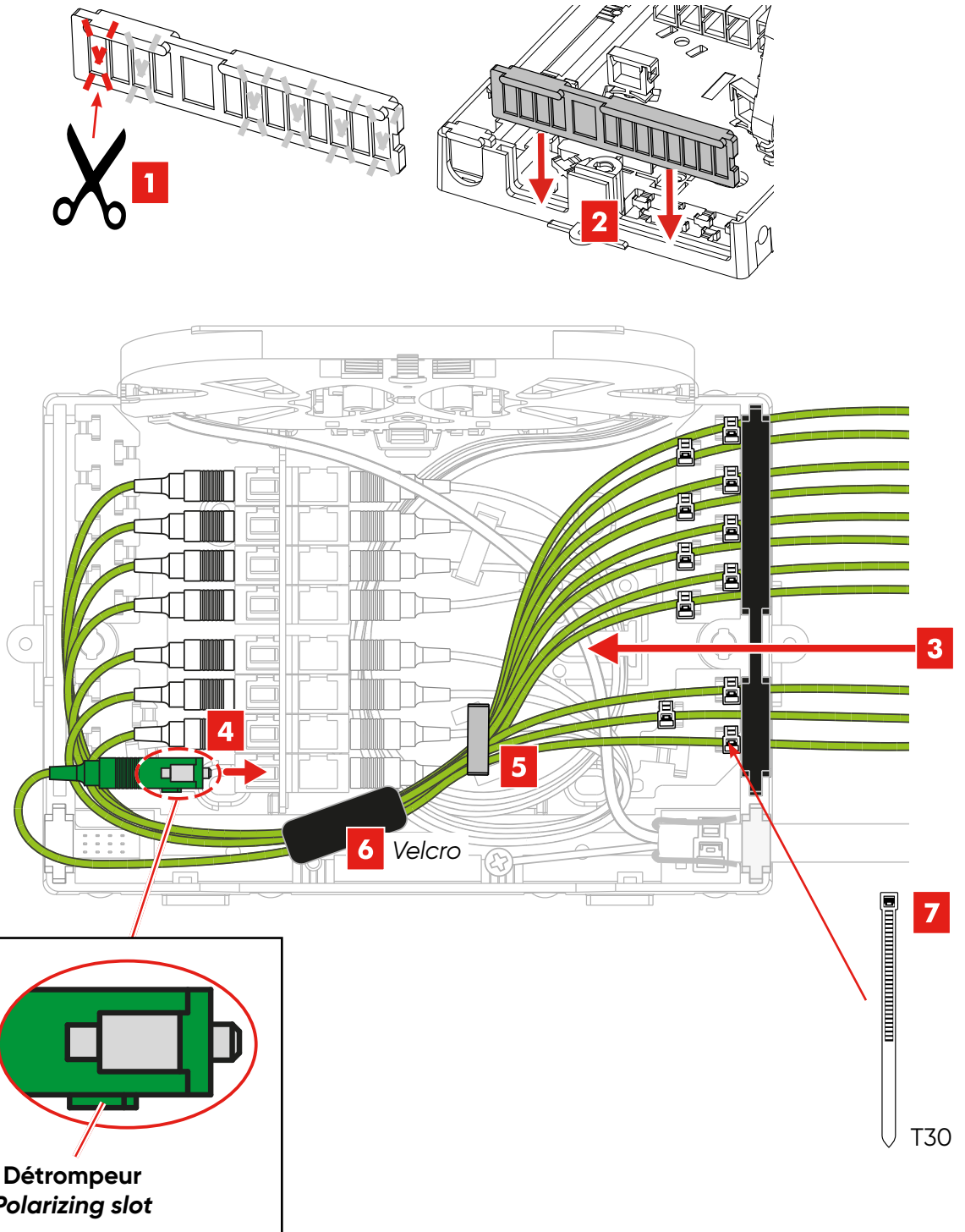

5.2. Câbles abonnés épissés sur pigtails
Subscriber cables spliced on pigtails

5.2.1. Mise en place des pigtails
Pigtails installation

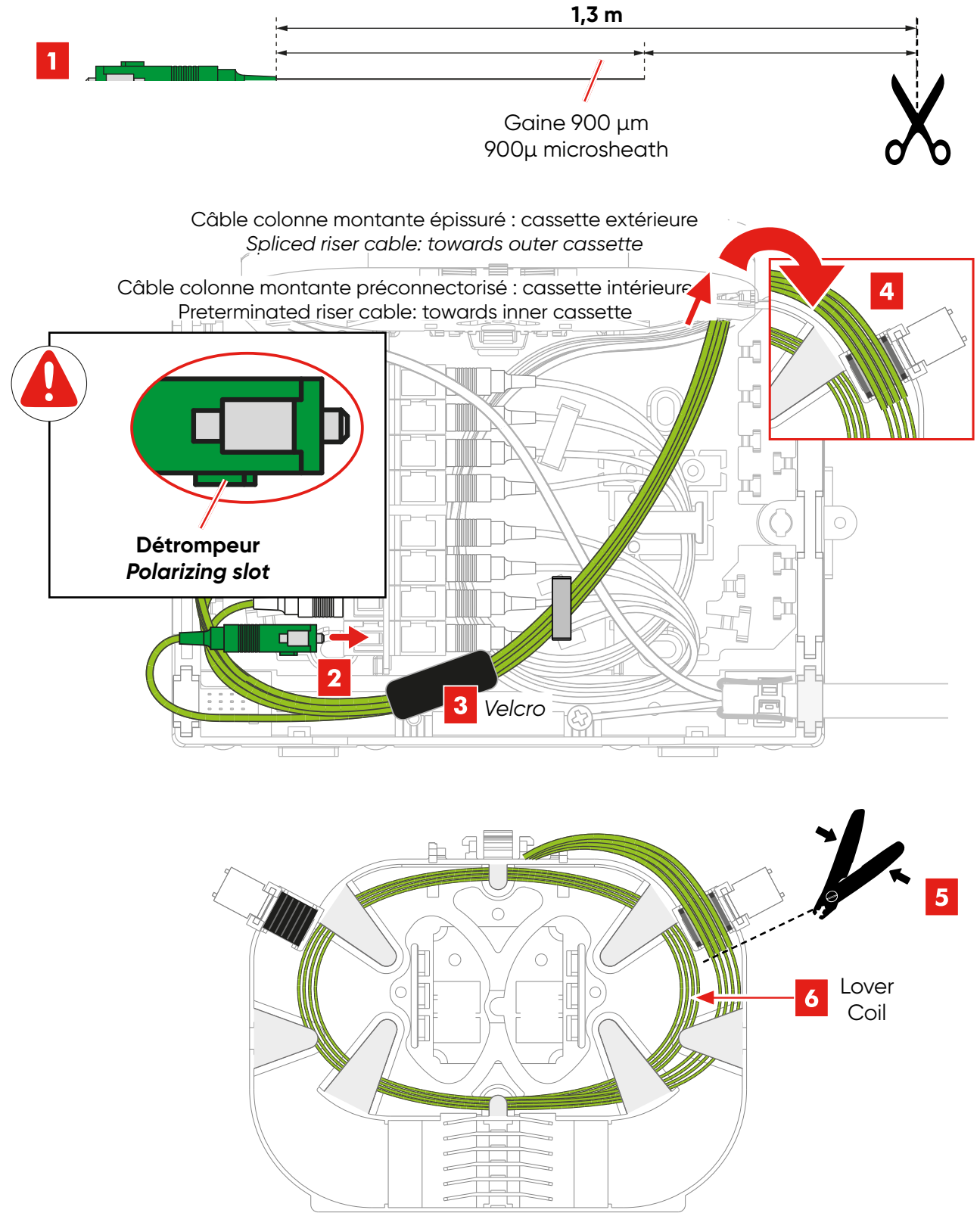

5.2.2. Mise en place des câbles abonnés
Subscriber cables installation

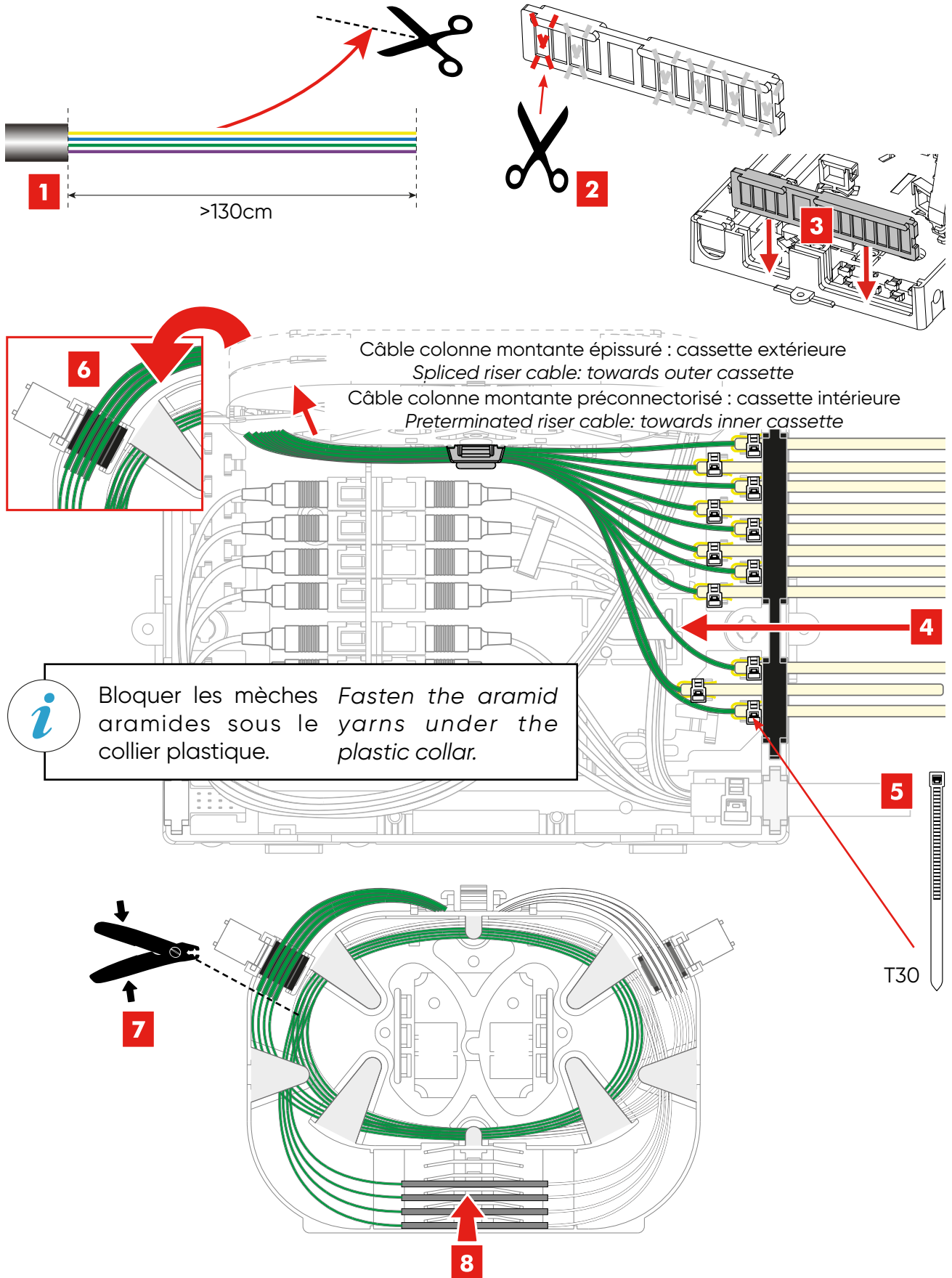

6. FERMETURE DU BOÎTIER BOX CLOSING

- 6.1. Boîtier installé sans jupes
Box installation without extension covers

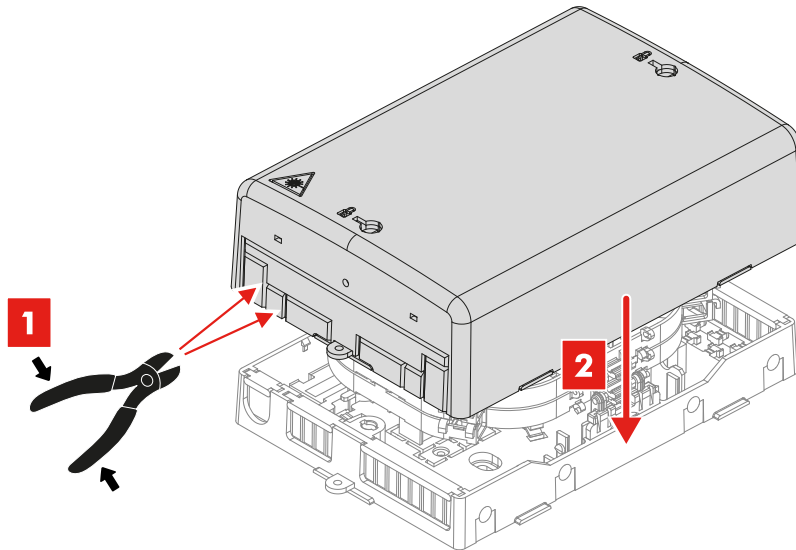

- 6.2. Boîtier installé avec jupes
Box installation with extension covers

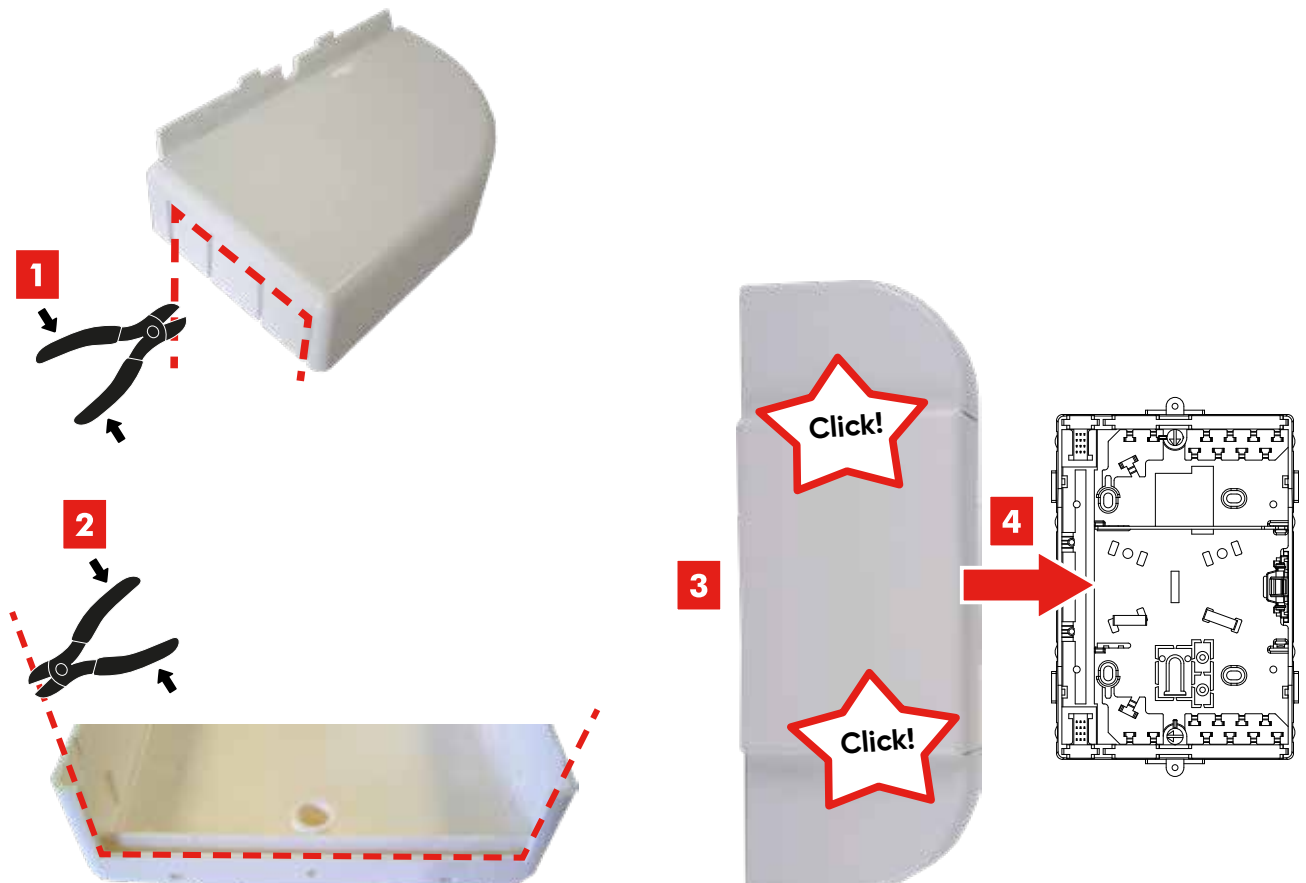

7. SÉCURISATION DU BOÎTIER
BOX SECURITY

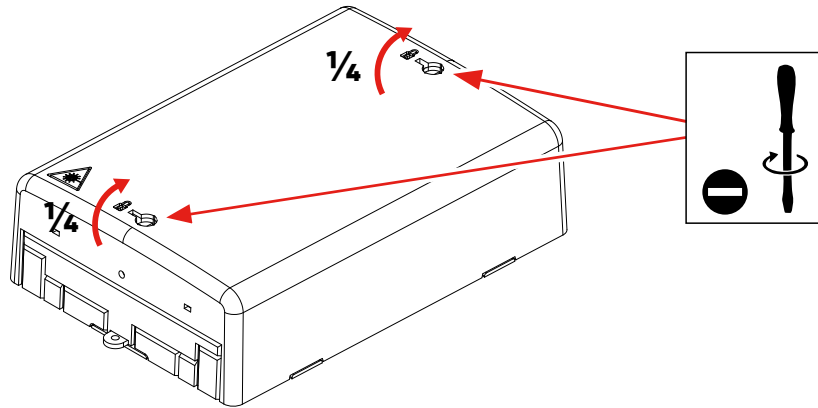

8. INSTRUCTIONS DE FIN DE VIE
END LIFE INSTRUCTIONS



Se connecter via LinkedIn
Connect via LinkedIn



En savoir plus sur Youtube
Learn more on YouTube

Visiter www.aginode.net
Visit www.aginode.net

Contactez-nous via
Contact us via
info@aginode.net

AGINODE
25, avenue Jean Jaurès
08330 Vrigne-aux-Bois
FRANCE
Tel. +33 (0) 3 24 52 61 61